

Bar Joist Attachment

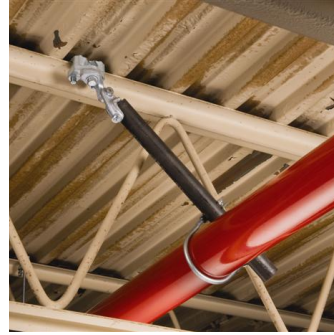

Features

- Can be installed on bar joists or I-beams
- Thumb spring retainer allows for ease of positioning
- Snap-off bolt head helps enable easy installation and inspection of seismic sway braces
- No assembly required
- No loose parts
- Meets NFPA®-13 requirements for seismic sway bracing

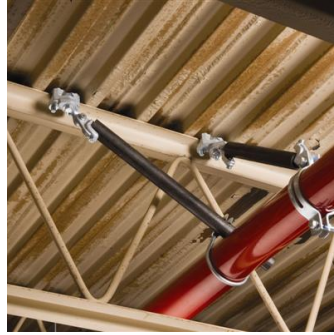
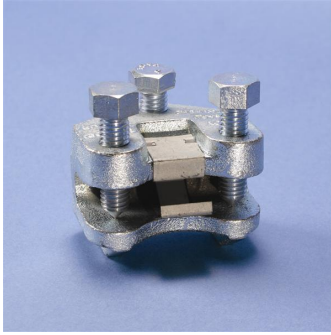
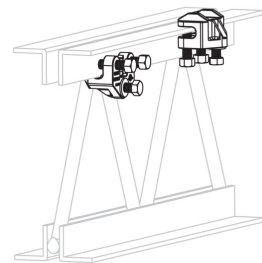
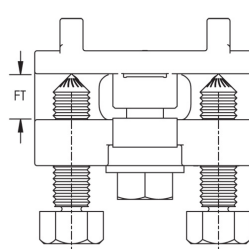
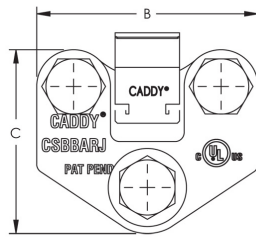
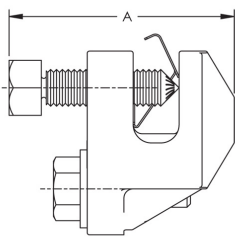

Specifications

Material: Steel

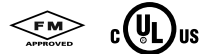

| Part Number | Flange Thickness FT | A | B | C |
|-----------------------------------|---------------------|---------|---------|---------|
| Finish: Electro-galvanized | | | | |
| CSBBARJEG | 6.4 – 12.7 mm | 50.8 mm | 76.2 mm | 63.5 mm |
| Finish: Hot-dip galvanized | | | | |
| CSBBARJHD | 6.4 – 12.7 mm | 50.8 mm | 76.2 mm | 63.5 mm |

| UL Loads | | |
|------------------------------|-------------------|---------|
| Brace Direction to Structure | Service Pipe Size | Rating |
| Parallel | 25 - 250 mm | 13340 N |
| Perpendicular | 25 - 300 mm | 16630 N |

| FM Loads | | | | | |
|-----------------|-------------------|---|-----------|-----------|-----------|
| Brace Direction | Service Pipe Size | Horizontal Capacity per Intallation Angle from Vertical | | | |
| | | 30° - 44° | 45° - 59° | 60° - 74° | 75° - 90° |
| Parallel | N/A | 6270 N | 9385 N | 11300 N | 12590 N |
| Perpendicular | N/A | 7740 N | 7605 N | 9165 N | 10230 N |

Adjustable I-Beam Attachment

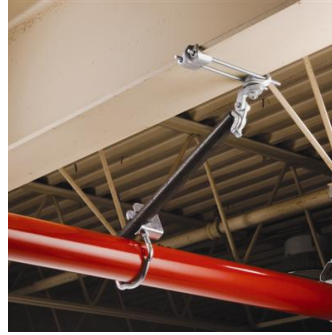

Features

- No loose parts
- No assembly required
- Snap-off bolt head helps enable easy installation and inspection of seismic sway braces
- Meets NFPA®-13 requirements for seismic sway bracing

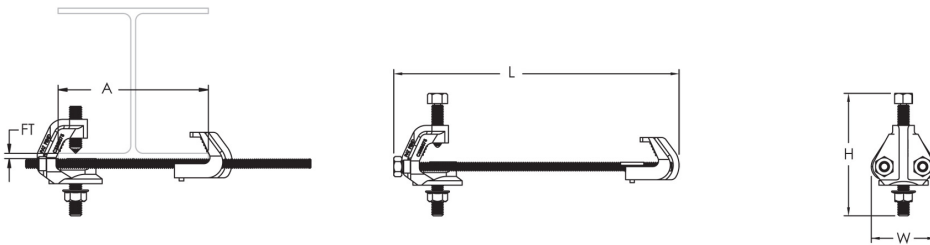

Specifications

Material: Steel

Finish: Electro-galvanized

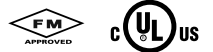

| Part Number | Flange Thickness FT | A | Height H | Length L | Width W |
|---------------|---------------------|--------------|----------|----------|---------|
| CSBIB075085EG | 6.4 – 19.1 mm | 100 – 216 mm | 63.5 mm | 304.8 mm | 69.9 mm |
| CSBIB075145EG | 6.4 – 19.1 mm | 216 – 368 mm | 63.5 mm | 431.8 mm | 69.9 mm |
| CSBIB125180EG | 19.1 – 31.8 mm | 100 – 457 mm | 88.9 mm | 546.1 mm | 79.4 mm |

| UL Loads | | |
|------------------------------|-------------------|---------|
| Brace Direction to Structure | Service Pipe Size | Rating |
| Parallel | 25 - 300 mm | 13340 N |
| Perpendicular | 25 - 300 mm | 16630 N |

FM Loads

| Brace Direction | Service Pipe Size | Horizontal Capacity per Installation Angle from Vertical | | | |
|-----------------|-------------------|--|-----------|-----------|-----------|
| | | 30° - 44° | 45° - 59° | 60° - 74° | 75° - 90° |
| Parallel | N/A | 7,205 N | 7,605 N | 4,495 N | 4,940 N |
| Perpendicular | N/A | 7,205 N | 10,230 N | 12,545 N | 13,965 N |

Multi Attachment

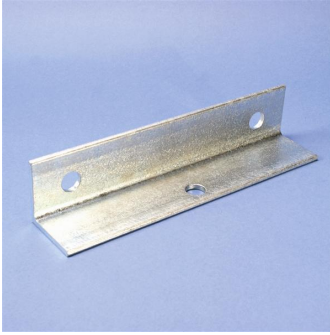

Features

- Disperses load over two anchors
- Minimizes the number of installed braces needed for concrete and wood structures
- Ideal for deck installations
- Use for both lateral and longitudinal sway brace applications
- Meets NFPA®-13 requirements for seismic sway bracing

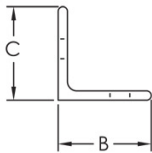
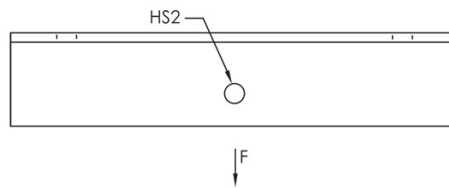
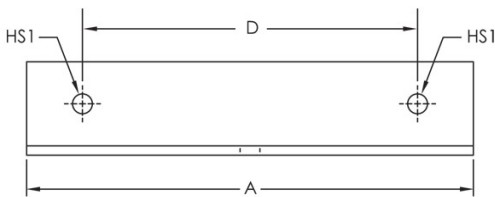

Specifications

Material: Steel

Finish: Electro-galvanized



| Part Number | Hole Size 1 HS1 | Hole Size 2 HS2 | A | B | C | D | UL Listed Load |
|---------------|--------------------|--------------------|----------|---------|---------|----------|----------------|
| CSBMA050050EG | 14 mm | 14 mm | 304.8 mm | 63.5 mm | 63.5 mm | 228.6 mm | 16,636 N |
| CSBMA050075EG | 20 mm | 14 mm | 304.8 mm | 63.5 mm | 63.5 mm | 228.6 mm | 16,636 N |

Mount to structure using holes indicated in HS1.

Universal Structural Attachment



Features

- Universal design allows one product to attach directly to concrete, wood, bar joist or I-beam adapters
- Snap-off bolt head helps enable easy installation and inspection of seismic sway braces
- Use for both lateral and longitudinal sway brace applications
- Works with 1" through 2" brace pipes and 1/4" angle iron braces to reduce inventory
- Center bolt does not require tightening
- Meets NFPA®-13 requirements for seismic sway bracing

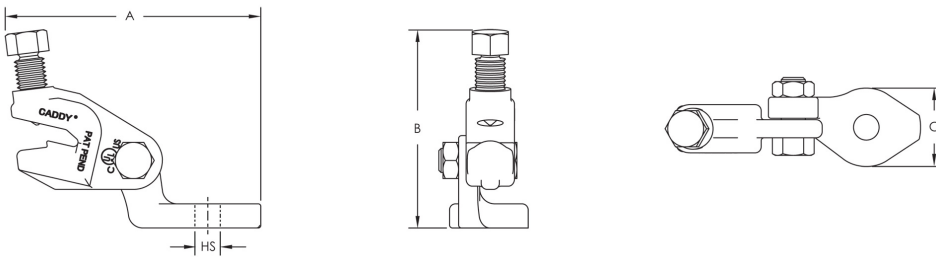

Specifications

Material: Steel
Finish: Electro-galvanized

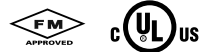

| Part Number | Hole Size HS | A | B | C |
|--------------|--------------|----------|----------|---------|
| CSBUNIV050EG | 14 mm | 133.4 mm | 101.6 mm | 41.4 mm |
| CSBUNIV075EG | 21 mm | 133.4 mm | 101.6 mm | 41.4 mm |

| UL® Loads | | |
|-----------------|-------------------|----------|
| Brace Type | Service Pipe Size | Rating |
| Pipe | 25 mm - 300 mm | 16,630 N |
| 6mm Thick Angle | 25 mm - 200 mm | 8,960 N |

| FM® Loads | | | | | |
|------------|-------------------|--|-----------|-----------|-----------|
| Brace Type | Service Pipe Size | Horizontal Capacity per Installation Angle from Vertical | | | |
| | | 30° - 44° | 45° - 59° | 60° - 74° | 75° - 90° |
| Pipe | N/A | 7,205 N | 10,230 N | 12,545 N | 13,965 N |

cULus is a registered certification mark of UL LLC. FM is a registered certification mark of FM Approvals LLC, LTD. NFPA is a registered trademark of National Fire Protection Association, Inc. UL is a registered certification mark of UL LLC.

WARNING
ERICO products shall be installed and used only as indicated in ERICO's product instruction sheets and training materials. Instruction sheets are available at www.erico.com and from your ERICO customer service representative. Improper installation, misuse, misapplication or other failure to completely follow ERICO's instructions and warnings may cause product malfunction, property damage, serious bodily injury and death.

WARRANTY
ERICO products are warranted to be free from defects in material and workmanship at the time of shipment. NO OTHER WARRANTY, WHETHER EXPRESS OR IMPLIED (INCLUDING ANY WARRANTY OF MERCHANTABILITY OR FITNESS FOR A PARTICULAR PURPOSE), SHALL EXIST IN CONNECTION WITH THE SALE OR USE OF ANY ERICO PRODUCTS. Claims for errors, shortages, defects or nonconformities ascertainable upon inspection must be made in writing within 5 days after Buyer's receipt of products. All other claims must be made in writing to ERICO within 6 months from the date of shipment or transport. Products claimed to be nonconforming or defective must, upon ERICO's prior written approval in accordance with its standard terms and procedures governing returns, promptly be returned to ERICO for inspection. Claims not made as provided above and within the applicable time period will be barred. ERICO shall in no event be responsible if the products have not been stored or used in accordance with its specifications and recommended procedures. ERICO will, at its option, either repair or replace nonconforming or defective products for which it is responsible or return the purchase price to the Buyer. THE FOREGOING STATES BUYER'S EXCLUSIVE REMEDY FOR ANY BREACH OF ERICO WARRANTY AND FOR ANY CLAIM, WHETHER SOUNDING IN CONTRACT, TORT OR NEGLIGENCE, FOR LOSS OR INJURY CAUSED BY THE SALE OR USE OF ANY PRODUCT.

LIMITATION OF LIABILITY
ERICO excludes all liability except such liability that is directly attributable to the willful or gross negligence of ERICO's employees. Should ERICO be held liable its liability shall in no event exceed the total purchase price under the contract. ERICO SHALL IN NO EVENT BE RESPONSIBLE FOR ANY LOSS OF BUSINESS OR PROFITS, DOWNTIME OR DELAY, LABOR, REPAIR OR MATERIAL COSTS OR ANY SIMILAR OR DISSIMILAR CONSEQUENTIAL LOSS OR DAMAGE INCURRED BY BUYER.

Copyright © 2012 ERICO International Corporation. All rights reserved.
CADDY, CADWELD, CRITEC, ERICO, ERIFLEX, ERITECH, and LENTON are registered trademarks of ERICO International Corporation.