



**Load capacity:** 125 kN test load EN 124

**Material:** Grade 304 stainless steel. Passivated after welding. Also available in grade 316 stainless steel on request.

**Features:** Accurately manufactured fully sealed access covers. Tapered design allows easy opening. Virtually invisible when installed. EPDM seal.

**The Lift-Off opening system:** Every **HAGO DECK Type BVE stainless steel cover** comes with a set of lifting keys and precise installation instructions. **The HAGO advantage:** jammed covers are released by simply turning the Golden Key.

**Applications:** Inside buildings or their surroundings, where exceptionally high standards are needed or where the hygienic properties of stainless steel are preferred, e.g. in the food industry, in meat-processing areas, dairies, hospitals, swimming pools. For indoor swimming pools only use grade 316 material!

**Installation:** Installation must be carried out according to our instructions. With water-tight models, care must be taken to seal the outer frame into the surrounding flooring.

**Specification clause:** [www.hago.at](http://www.hago.at)



**BVE**

In use at a food processing plant

### BVE stainless steel

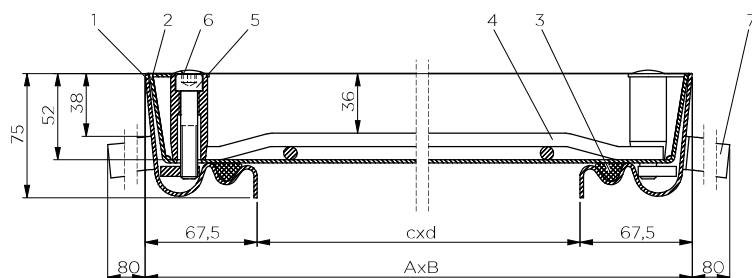

- |         |                 |          |
|---------|-----------------|----------|
| 1 Frame | 4 Reinforcement | 7 Anchor |
| 2 Cover | 5 Allen screw   |          |
| 3 Seal  | 6 Plastic cap   |          |

Type	Clear dimensions of shaft (≈ cm)	Outside dimensions (≈ cm)	Weight empty approx.	S / O*
	c x d	A x B		
BVE 22	20 x 20	33,5 x 33,5	7 kg	S
BVE 33	30 x 30	43,5 x 43,5	10 kg	S
BVE 44	40 x 40	53,5 x 53,5	13 kg	S
BVE 55	50 x 50	63,5 x 63,5	16 kg	S
BVE 64	60 x 40	73,5 x 53,5	16 kg	S
BVE 66	60 x 60	73,5 x 73,5	20 kg	S
BVE 635	63,5 x 63,5	77,0 x 77,0	21 kg	S
BVE 77	70 x 70	83,5 x 83,5	26 kg	O
BVE 86	80 x 60	93,5 x 73,5	24 kg	S
BVE 88	80 x 80	93,5 x 93,5	29 kg	S
BVE 106	100 x 60	113,5 x 73,5	28 kg	S
BVE 108	100 x 80	113,5 x 93,5	34 kg	S
BVE 110	100 x 100	113,5 x 113,5	40 kg	S

Cover depth ≈ 5,0 cm

Installation height ≈ 7,5 cm

**Special sizes possible**

\*S = available from stock

\*O = to order