



BV-F90 steel BVE-F90 stainless steel

fire resistance class REI 120 (a <-> b), sealed access cover



Load capacity: 125 kN test load EN 124

Material: Frame and cover made of 2 mm cold-formed precision steel profiles, hot-dip galvanized or stainless steel grade 1.4301 (grade 1.4571 also available on request). Fire protection panel on stainless steel Z-brackets, EPDM seal and fire resistant seal.

Features: Accurately-manufactured smell proof access cover. Tapered design allows easy opening. Virtually invisible when installed. Robust steel mesh reinforcement.

Fire test certificate: The Austrian test certificate issued by the Institute for Fire Protection Technology and Safety Research (IBS) confirms that **HAGODECK Type BV-F90 steel** resists a fire for 120 minutes and thus significantly contributes to safety in the event of a fire. In accordance with EN 13501-2, **Type BV-F90 is classified in fire resistance class REI 120 (a <-> b).**

The Lift-Off opening system: Every **HAGODECK Type BV-F90 steel** cover comes with a set of lifting keys and precise installation instructions. After lifting out the cover, the fire protection panel can be removed using its grab handle. The shaft is then accessible without restriction.

The HAGO advantage: jammed covers are released by simply turning the Golden Key.

Applications: Access covers inside buildings that are required to be fire-resistant.

Installation: Installation must be carried out according to our instructions. With water-tight models, care must be taken to seal the outer frame into the surrounding flooring.

Specification clause: www.hago.at

Other versions available in fire-proof finish (including test certificate):

- Multi-part covers (on request)

BV-F90 steel/BVE-F90 stainless steel

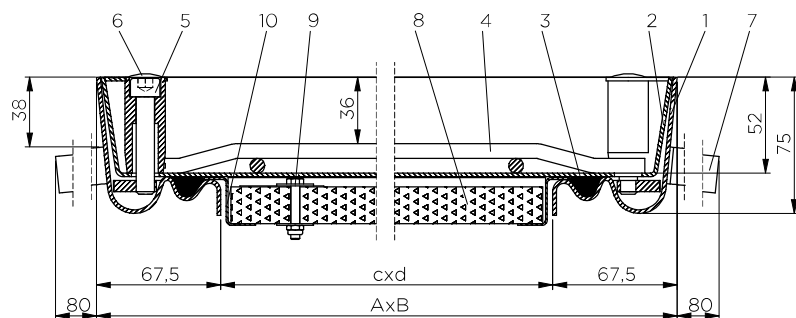

- | | | |
|-------------------------|-------------------------|--------------------------------|
| 1 Frame | 5 Allen screw | 9 Grab handle with blind rivet |
| 2 Cover | 6 Plastic cap | 10 Stainless steel Z-bracket |
| 3 Seal (fire-resistant) | 7 Anchor | |
| 4 Reinforcement | 8 Fire protection panel | |

Type	Clear dimensions of shaft (≈ cm)	Outside dimensions (≈ cm)	Weight empty approx.	S / O*
Galvanised steel				
BV-F90 33	30 x 30	43,5 x 43,5	13 kg	S
BV-F90 44	40 x 40	53,5 x 53,5	19 kg	S
BV-F90 45	45 x 45	58,5 x 58,5	21 kg	S
BV-F90 55	50 x 50	63,5 x 63,5	23 kg	S
BV-F90 64	60 x 40	73,5 x 53,5	23 kg	S
BV-F90 66	60 x 60	73,5 x 73,5	30 kg	S
BV-F90 635	63,5 x 63,5	77,0 x 77,0	32 kg	S
BV-F90 86	80 x 60	93,5 x 73,5	38 kg	S
BV-F90 88	80 x 80	93,5 x 93,5	45 kg	S
BV-F90 106	100 x 60	113,5 x 73,5	45 kg	S
BV-F90 108	100 x 80	113,5 x 93,5	54 kg	S
BV-F90 110	100 x 100	113,5 x 113,5	63 kg	S
Stainless steel				
BVE-F90 33	30 x 30	43,5 x 43,5	13 kg	S
BVE-F90 44	40 x 40	53,5 x 53,5	19 kg	S
BVE-F90 55	50 x 50	63,5 x 63,5	23 kg	S
BVE-F90 64	60 x 40	73,5 x 53,5	23 kg	S
BVE-F90 66	60 x 60	73,5 x 73,5	30 kg	S
BVE-F90 635	63,5 x 63,5	77,0 x 77,0	32 kg	S
BVE-F90 86	80 x 60	93,5 x 73,5	38 kg	S
BVE-F90 88	80 x 80	93,5 x 93,5	45 kg	S
BVE-F90 106	100 x 60	113,5 x 73,5	45 kg	S
BVE-F90 108	100 x 80	113,5 x 93,5	54 kg	S
BVE-F90 110	100 x 100	113,5 x 113,5	63 kg	S

Cover depth ≈ 5.0 cm, Installation height ≈ 7.5 cm

Special sizes possible

*S = available from stock *O = to order