



Uniclass			
L731			
CI/SfB	(52.5)	lh	

A global leader in
surface water drainage

2016



Product Guide

Best products. Best service. Best results.

Gatic is a global leader in engineered surface water drainage and access covers. Established since 1928, our highly specified civil drainage range is well recognised for innovation, quality and performance across many prestigious projects in the construction, transport and utility markets.

Our range includes engineered gas and air-tight access covers, heavy duty access covers, Slotdrain surface water drainage systems, channel drainage and linear drainage. Our gas and airtight access covers are the international standard, while our flagship Slotdrain hexagonal channel profile was originally developed in conjunction with industry professionals from the airport sector. Gatic products and systems help to keep the world's major ports and airports open. We are constantly improving and developing our range to match the demands of ever-increasing weight and volume of traffic and provide the ultimate protection in severe weather conditions.

Rain to Drain solution

Gatic's innovative range of surface water drainage is also supplied by Alumasc Group, under its umbrella brand: Alumasc Water Management Solutions (AWMS).

AWMS is a leading brand in the industry for proven water management. It harnesses the expertise of four trusted brands:

- **Skyline** (Fascia, Soffit and Copings)
- **Alumasc Rainwater** (Gutters and Downpipes)
- **Harmer Building Drainage**
- **Gatic Civil Drainage**

Uniquely, these four brands represent a complete rain to drain solution which starts at the roof and deals with water from its source: capturing, cleansing, controlling, and channelling water safely back into the water course. It is the kind of joined up thinking we adopt at the design stage to help protect our buildings, people and environment from changes in our climate and increasing levels of rainfall.

www.alumascwms.co.uk



Drainage Product Guide

Contents

Best Service	4-5
Quality and the Environment	6
Loading class	7
Applications	8-9

Slotdrain

Range Overview	12-13
Product Selector	14-17
CastSlot	14
UltraSlot	15
PaveSlot	16
FacadeSlot	17
Slotdrain accessories	18
Product tables	20-39

Filcoten

Range Overview	42-43
Product Selector	44-48
Filcoten Pro G	44
Filcoten Pro V	45
Filcoten Tec	46
Filcoten Self	47
Filcoten Pave	48
Accessories & Gratings	49
Filcoten Green	50-51
Product tables	52-67

ProSlot

Range Overview	70-71
Product Selector	72-73
ProSlot Cast	72
ProSlot Pave	73
ProSlot tables	74-75

Harmer SML

Range Overview	78
Product Range	79-81



Best Service

Technical Support

Gatic's wide range of slot and channel drains is backed by the fastest technical response and the most extensive support.

Our hands-on approach ensures customers get the best support every step of the way, from technical design through to installation. Our technical team is also accessible for site visits.

Rapid response design service

We aim to turn around the design of drainage systems, complete with quantities and delivery time scales, within 24 hours. Send us your drainage layout and we will produce the design for you.

Email: technical@gatic.com or call +44 (0)1304 203 545

FREE Drainage Design Software

Our Design and Engineering software for slot and channel drains (Slotrain, Filcoten and ProSlot) is online at www.gatic.com. This programme takes you through the complete process of designing a slotrain or channel drain system that will meet the requirements of your project. It is the same software that is developed for and used by our own engineers to plan the most advanced surface water drainage schemes in the world.

If you'd like the USB containing this free software, simply register your details on our website. You can also do this on the MyGatic section of our website, or by emailing or phoning us using the contact information in this brochure.



Gatic Slotdrains designed in DrawNet using graphical user interface in 3D worldview

BIM Compliance with MicroDrainage Software

We have added our highly specified range of Slotrain channel and Filcoten drainage to XP Solutions' MicroDrainage software (Version 2016.1). This development means Gatic can now provide a BIM (Building Information Modelling) Level 2 compliant solution.

MicroDrainage is a well-recognised tool for civil engineers working on surface water and external drainage calculations. It is the industry standard software to detail design fully integrated storm-water and foul water drainage systems. Users of MicroDrainage benefit from a user-friendly interface, interaction with third party CAD software, and an auto-design and editing facility.

Along with the usual functionality, MicroDrainage will include a Gatic Slotrain parts list that is available in Network and within AutoCAD Civil 3D through the DrawNet(CAD) interface. The advantage is that normal design workflows will be maintained and the resulting drainage design that is generated through MicroDrainage will be BIM compliant. This can then be exported into a program like Navisworks or similar for different file types.

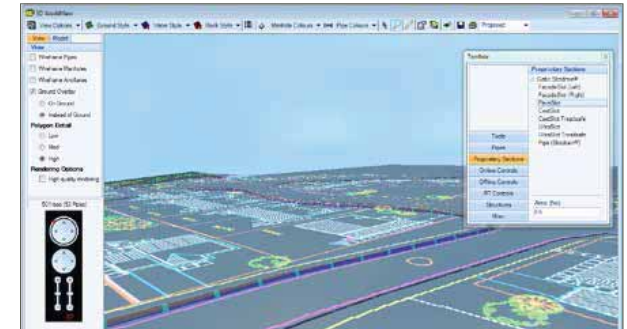

Designing Gatic Slotdrains in System 1 using spreadsheet format

CPDs

We also offer CPD presentations at your premises covering all aspects of surface water drainage and attenuation. Our presentations are accredited by the CPD Certification Service and count towards the continuing personal and professional development of attendees. It's a factor worth bearing in mind for those individuals seeking professional membership. The CPD presentations currently available are Innovative Surface Water Drainage Design and Access Covers. Visit www.gatic.com for more information or to book your place.



NBS Plus

Our technical product information is included in this dedicated library of manufacturers' product information, contained within the UK's industry leading specification products NBS Building, NBS Landscape, NBS Engineering Services and NBS Scheduler.

Products listed in NBS Plus are directly linked to specific clauses and can be imported instantaneously into a specification. NBS Plus contains over 20,000 product specifications and is updated regularly, so designers can be confident that they are always referencing the very latest product information.

Links of all Gatic products on the NBS Plus Product Register are available on our website.

www.gatic.com

Our website now contains even more technical information and guidance than before. We have increased our online resources and improved the website design so you can now find all the technical information you need for your projects easily and quickly.

Within each product range, you can explore features and benefits, technical details, graphics, diagrams, and case studies.

By setting up a MyGatic account (registering your name and email address), you can store all the literature, technical specifications and images that you have collected while browsing, and access them again anytime from your MyGatic page simply by logging in.



Quality

Our products have been tested in accordance with recognised standards, providing reassurance to industry professionals that our channel systems have proven performance. These include:

- **ISO 9001** - the recognised standard for the improvement of product, process and service quality.
- **European Standard EN 1433 'Drainage Channels for Vehicular and Pedestrian Areas'** - the only internationally recognised standard written specifically for trench drainage and slot drain systems. This uses the load classifications between A15 and F900.
- **BS EN 877** - Cast iron pipes and fittings, their joints and accessories for the evacuation of water from buildings. Requirements, test methods and quality assurance.



Bath City Centre



Andover Business Park



Sustainability and the environment

Gatic is focused on providing effective solutions that enhance sustainability in the built environment. We are committed to adopting environmentally sound business practices throughout our operations and are well positioned to benefit from environmentally-driven changes in policy and regulation. In particular, the growing awareness of sustainability and life-cycle cost among building and construction specifiers.

We work to the following standards:

- **Environmental Management Standard ISO 14001** - our programme of environmental audits, carried out by external consultants, are designed to highlight areas in which we can improve, and form a basis for us achieving this standard.
- **Energy Management BS EN ISO 50001** - Filcoten complies with ISO 50001. This is based on the management system model of continual improvement, used for other well-known standards such as ISO 9000 or ISO 14001 for quality and environmental management.
- **BREEAM** - the world's foremost environmental assessment method and rating system for buildings. Design teams use BREEAM as a method to improve the performance of their buildings and their own experience and knowledge of environmental aspects of sustainability. Gatic's channels have been used on a number of projects associated with BREEAM.

Slotrain – Highly efficient surface water drainage for all applications, from airports to shopping centres and urban landscaping.

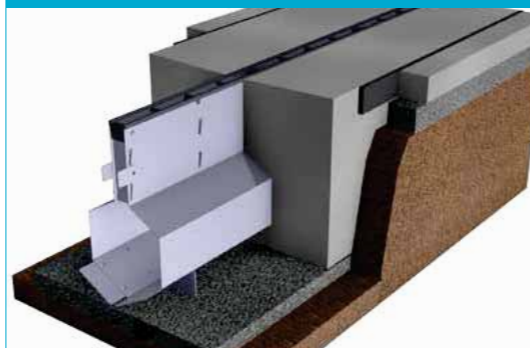

	Loading class A15
	Loading class B125
	Loading class C250
	Loading class D400
	Loading class E600
	Loading class F900

Filcoten – The sustainable channel-based drainage range offering an innovative alternative approach for all types applications.



	Loading class A15
	Loading class B125
	Loading class C250
	Loading class D400
	Loading class E600
	Loading class F900

ProSlot – An instant version of Slotrain, available off the shelf and pre-assembled for quick and easy installation.



	Loading class A15
	Loading class B125
	Loading class C250
	Loading class D400

Applications

Our market leading range of surface water drainage ensures we can provide the best solution for your commercial or domestic projects. Below is a summary of the various applications our range covers.

In a climate where we are experiencing more frequent and extreme rainfall, it is increasingly important our roads, pavements, motorways and other similar infrastructure are protected from the build up of excess rainwater. All our products are designed to manage the discharge of surface water efficiently and effectively.

Landscaping and Pedestrian Schemes

Landscaping and pedestrian schemes include domestic driveways and paved areas. For these projects the aesthetics and design of the slot or channel drain is important to ensure it is discreet and fits seamlessly with the surrounding environment.



Car Parks

In car parks, slow turning traffic and a constant flow of vehicles make for a demanding and harsh environment for any surface water drainage system. Strength and durability of the slot or channel drain are essential in these high traffic areas.



Highways and Motorways

Highways and motorways are under constant strain from heavy traffic and vehicles of various sizes. It's important the surface drainage can manage large volumes of rainfall so that the road remains free and safe from excess water.



Distribution Yards and Industrial Units

Distribution yards and industrial units typically have large surface areas to drain and must cope with heavy loads manoeuvring on a daily basis.



Shopping Centres and Retail Parks

Shopping centres and retail parks need unobtrusive but effective drainage to maintain an attractive environment. Looks, style and performance are all important characteristics for these projects.



Petrol Stations and Forecourts

Petrol stations and forecourts mean wide open spaces and constant weight of traffic. Robustness of the slot or channel drain is essential.



Bus Terminals

Bus terminals and public transport facilities place heavy demands on surfaces and infrastructure. Strength and reliability are key criteria.



Container Ports and Distribution Yards

Container ports and distribution yards are extremely hostile environments, pounded continuously by tractor and trailer units. Our robust range of slotdrain and channel systems have been specifically developed with this in mind.



Ports and Docks

Large ports and dock facilities are occupied by heavy, slow moving cranes that place high demands on the surface drainage. Only products with the highest specification are fit for this purpose.



Airports

Airports around the world are seeing movements increase year-on-year and aircraft weights reaching new heights. With super jumbos like the Airbus A380, airside drainage is ever more of a challenge.



GATIC® Slotdrain

Overview

Our core business has traditionally been driven by our success in meeting the heavy demands of the world's major ports and airports. Gatic's Slotrain® hexagonal channel profile was originally developed in conjunction with industry professionals from the airport sector.

The concept has proved infinitely scalable and has been developed into a comprehensive range of products suitable for smaller projects such as landscaping schemes, shopping developments and parking facilities.

The current Slotrain range consists of **CastSlot**, **UltraSlot**, **PaveSlot** and **FacadeSlot** for total design flexibility, and includes complementary accessories. All channels are manufactured in 3 metre, 1 metre and 0.5 metre lengths of galvanised steel, benefitting from fewer joints and improved flow performance. Bespoke units are available on request to suit specific design requirements and are also available in stainless steel.

Gatic Slotrain channels are suitable for applications up to F900 (depending on the system type). The hexagonal profile ensures our systems can handle everything from a rain drop to a rainstorm with similar efficiency. The V-shaped channel base aids a self-cleansing flow, and a tapered throat helps prevent blockages.

*Patented

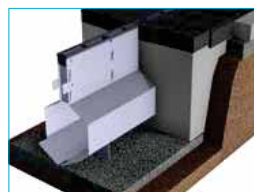

CastSlot



PaveSlot

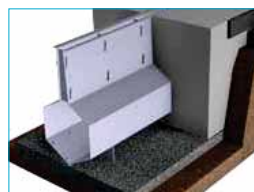

UltraSlot

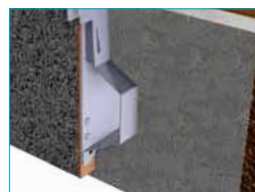

FacadeSlot

Sustainable

Gatic Slotrain is mechanically assembled, which eliminates welding and minimises energy usage in the manufacturing process. A significant proportion of the raw materials used are from recycled sources. Slotrain is manufactured from sheet steel and is 100% recyclable.

Site Work and Maintenance Guide

Our illustrated literature includes advice and general information on safe handling, installation and maintenance of our Slotrain products. This can be downloaded from our website www.gatic.com. Alternatively, email or phone us to request a copy.

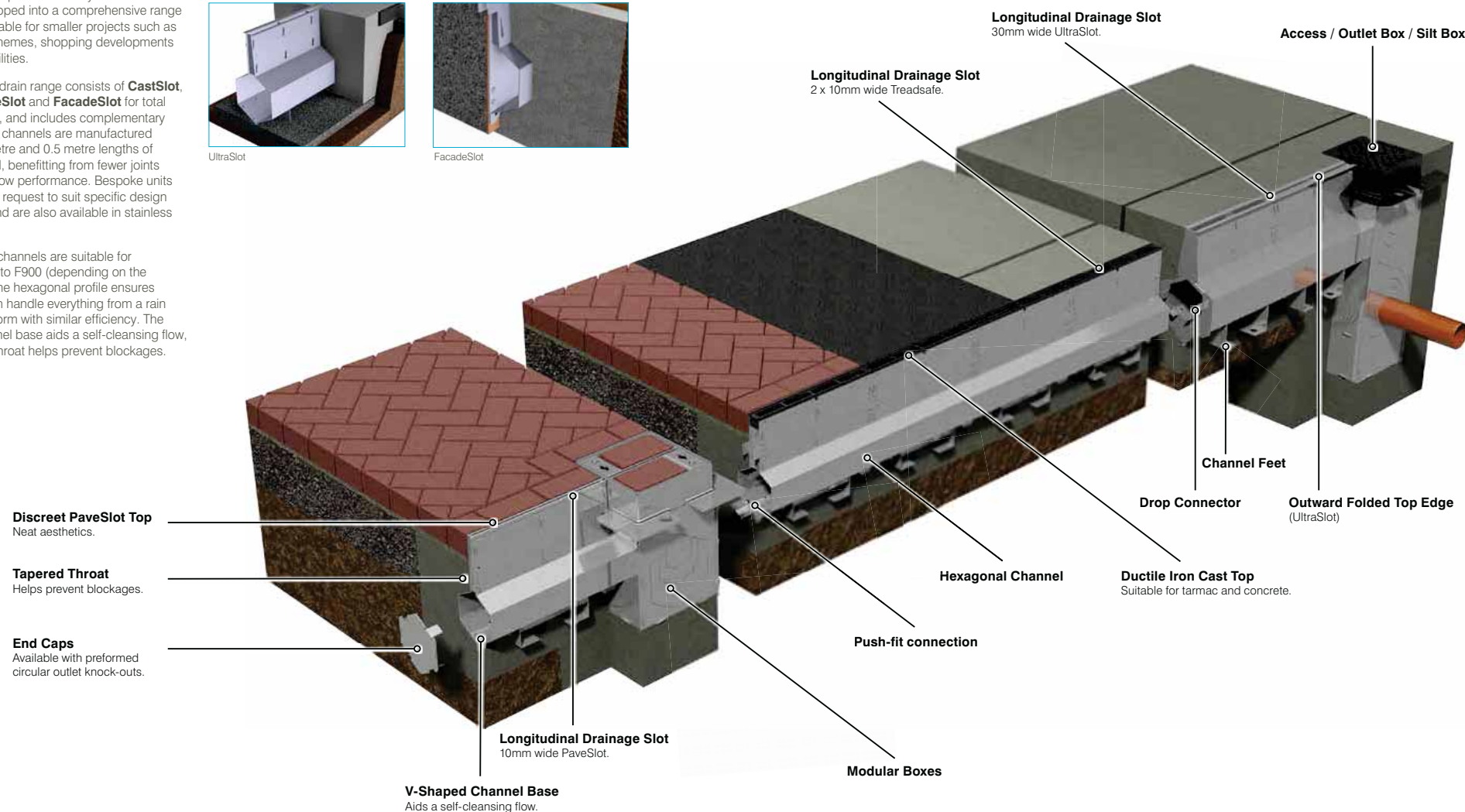

Gatic CastSlot and CastSlot Treadsafe

The unobtrusive profile of CastSlot sits neatly within concrete, asphalt and block surface finishes.

CastSlot features an electro painted ductile iron throat section, which is securely fixed to the galvanised steel channel body to provide an exceptionally robust yet discreet drainage system.

CastSlot is ideal for areas of vehicular traffic such as car parks and industrial units where there is slow turning traffic. Available with a 30mm opening and a Treadsafe option, which reduces the slot opening from 30mm wide to 2 x 10mm wide slots.

Load classification A15 to F900



Applications:

- Landscaping and Pedestrian Schemes
- Car Parks
- Highways and Motorways
- Distribution Yards & Industrial Units
- Petrol Stations and Forecourts
- Bus Terminals
- Container Ports and Distribution Yards
- Ports and Docks
- Airports

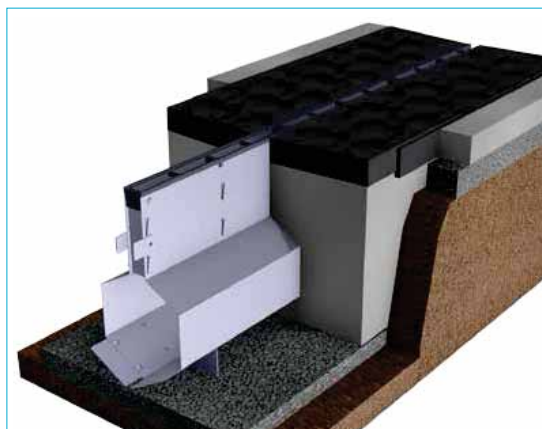

Gatic UltraSlot and UltraSlot Treadsafe

UltraSlot is used in external pavement areas such as airports, ports, highways and similar areas. The system is designed to withstand infrequent ultra heavy-duty loads.

A Treadsafe option is available, which reduces the slot opening from 30mm wide to 2 x 9mm wide slots. This has no effect on the intake capacity of the system but will make the channel safe to cross for pedestrians.

Load classification: A15 to F900



Applications:

- Highways and Motorways
- Distribution Yards & Industrial Units
- Shopping Centres and Retail Parks
- Petrol Stations and Forecourts
- Bus Terminals
- Container Ports and Distribution Yards
- Ports and Docks
- Airports

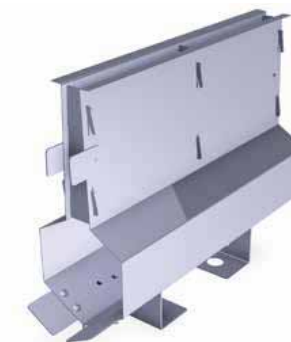
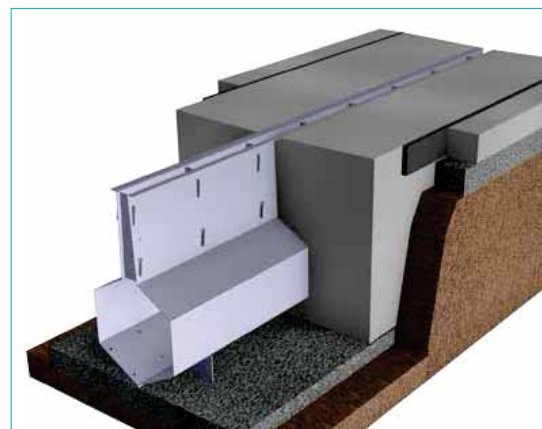

Slotdrain product selector

Gatic PavSlot

PaveSlot is used to drain external hard surface areas where a neat, unobtrusive aesthetic is required. The system is used with paving units laid against the top edge of the channel.

The system is suitable for all paved areas, in public and commercial projects.

Load classification: A15 to C250



Applications:

- Landscaping and Pedestrian Schemes
- Shopping Centres and Retail Parks

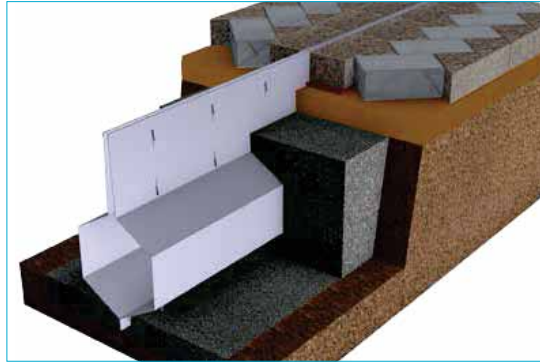

Gatic FacadeSlot

A discreet surface drainage channel that can be installed against a building, wall or other external landscape feature, to provide effective drainage from vertical surfaces, door thresholds and adjacent pavement areas.

FacadeSlot channels can be made to follow the building perimeter whether straight or curved. The system can accommodate rainwater downpipes which, when positioned over a simple rainwater inlet box, can eliminate the need for a separate drainage network for the roof area, achieving a more efficient drainage system.

Load classification A15



Applications:

- Landscaping and Pedestrian Schemes
- Shopping Centres and Retail Parks



Slotdrain product selector

Accessories

A comprehensive range of accessories is available to suit every conceivable system design.

The range of standard accessories (shown here) is available to suit all types and sizes of Slotdrain channels.

- Cover and gratings are delivered with locking bolts.



Access box -
shown with grating



Outlet box -
shown with grating



Silt box -
shown with recessed cover



Universal end caps



Drop connector



Channel pipes



Catchpit connectors



Flow regulators

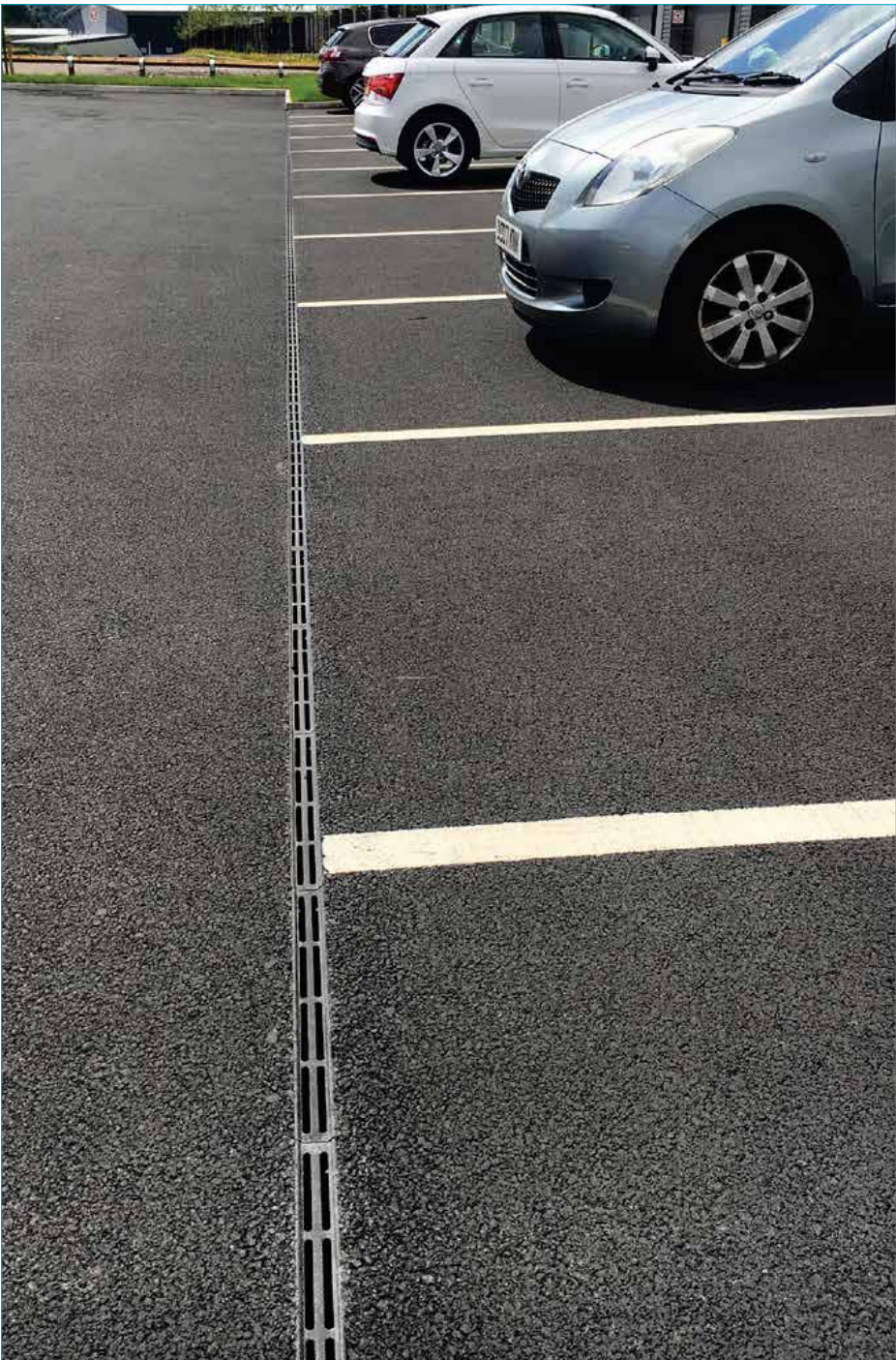

Slotdrain product selector

Gatic CastSlot



CastSlot 3m Channels

Code	Description	Load Rating	Surface Finish	Length (mm)		Width (w) (mm)	Height (h) (mm)	Invert (I) (mm)	Throat Depth (T1) (mm)	Throat Width (mm)	Slot Orifice (mm)	Intake Area/ Metre (m ²)	Weight (kg)
CA00001	100mm CastSlot - 3m	Up to F900	Concrete / Asphalt / Paving	3000		100	357	308	200	51	30	26350	43.3
CA00002	150mm CastSlot - 3m	Up to F900	Concrete / Asphalt / Paving	3000		150	415	366	200	51	30	26350	49.5
CA00003	225mm CastSlot - 3m	Up to F900	Concrete / Asphalt / Paving	3000		225	501	452	200	51	30	26350	59.7
CA00004	300mm CastSlot - 3m	Up to F900	Concrete / Asphalt / Paving	3000		300	587	538	200	51	30	26350	68.9
CA00005	350mm CastSlot - 3m	Up to F900	Concrete / Asphalt / Paving	3000		350	645	596	200	51	30	26350	75.1
CA00006	400mm CastSlot - 3m	Up to F900	Concrete / Asphalt / Paving	3000		400	712	652	200	51	30	26350	124.8
CA00007	500mm CastSlot - 3m	Up to F900	Concrete / Asphalt / Paving	3000		500	828	768	200	51	30	26350	145.4
CA00008	600mm CastSlot - 3m	Up to F900	Concrete / Asphalt / Paving	3000		600	1091	1031	200	51	30	26350	215.1

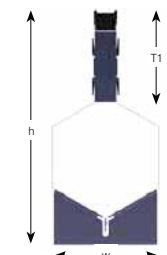

CastSlot 1m Channels

Code	Description	Load Rating	Surface Finish	Length (mm)		Width (w) (mm)	Height (h) (mm)	Invert (I) (mm)	Throat Depth (T1) (mm)	Throat Width (mm)	Slot Orifice (mm)	Intake Area/ Metre (m ²)	Weight (kg)
CA00009	100mm CastSlot - 1m	Up to F900	Concrete / Asphalt / Paving	1000		100	357	308	200	51	30	26350	15.2
CA00010	150mm CastSlot - 1m	Up to F900	Concrete / Asphalt / Paving	1000		150	415	366	200	51	30	26350	17.3
CA00011	225mm CastSlot - 1m	Up to F900	Concrete / Asphalt / Paving	1000		225	501	452	200	51	30	26350	21.5
CA00012	300mm CastSlot - 1m	Up to F900	Concrete / Asphalt / Paving	1000		300	587	538	200	51	30	26350	24.6
CA00013	350mm CastSlot - 1m	Up to F900	Concrete / Asphalt / Paving	1000		350	645	596	200	51	30	26350	26.7
CA00014	400mm CastSlot - 1m	Up to F900	Concrete / Asphalt / Paving	1000		400	712	652	200	51	30	26350	45.2
CA00015	500mm CastSlot - 1m	Up to F900	Concrete / Asphalt / Paving	1000		500	828	768	200	51	30	26350	52.2
CA00016	600mm CastSlot - 1m	Up to F900	Concrete / Asphalt / Paving	1000		600	1091	1031	200	51	30	26350	75.5

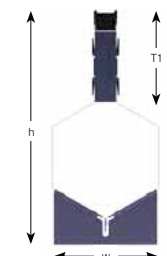

CastSlot 500mm Channels

Code	Description	Load Rating	Surface Finish	Length (mm)		Width (w) (mm)	Height (h) (mm)	Invert (I) (mm)	Throat Depth (T1) (mm)	Throat Width (mm)	Slot Orifice (mm)	Intake Area/ Metre (m ²)	Weight (kg)
CA00017	100mm CastSlot - 500mm	Up to F900	Concrete / Asphalt / Paving	500		100	357	308	200	51	30	26350	8.1
CA00018	150mm CastSlot - 500mm	Up to F900	Concrete / Asphalt / Paving	500		150	415	366	200	51	30	26350	9.2
CA00019	225mm CastSlot - 500mm	Up to F900	Concrete / Asphalt / Paving	500		225	501	452	200	51	30	26350	11.8
CA00020	300mm CastSlot - 500mm	Up to F900	Concrete / Asphalt / Paving	500		300	587	538	200	51	30	26350	13.4
CA00021	350mm CastSlot - 500mm	Up to F900	Concrete / Asphalt / Paving	500		350	645	596	200	51	30	26350	14.5
CA00022	400mm CastSlot - 500mm	Up to F900	Concrete / Asphalt / Paving	500		400	712	652	200	51	30	26350	25.3
CA00023	500mm CastSlot - 500mm	Up to F900	Concrete / Asphalt / Paving	500		500	828	768	200	51	30	26350	28.9
CA00024	600mm CastSlot - 500mm	Up to F900	Concrete / Asphalt / Paving	500		600	1091	1031	200	51	30	26350	40.6

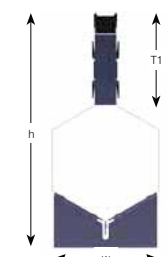

CastSlot Drop Connectors

Code	Description		From Channel Width (mm)	To Channel Width (mm)	Weight (kg)
00155	100-150mm Drop Connector		100	150	0.4
00156	150-225mm Drop Connector		150	225	0.7
00157	225-300mm Drop Connector		225	300	1
00158	300-350mm Drop Connector		300	350	0.9
00159	350-400mm Drop Connector		350	400	1.7
00160	400-500mm Drop Connector		400	500	2.7
00161	500-600mm Drop Connector		500	600	5.9



Slotdrain product selector

Gatic CastSlot Treadsafe

CastSlot Treadsafe 3m Channels



Code	Description	Load Rating	Surface Finish	Length (mm)		Width (w) (mm)	Height (h) (mm)	Invert (I) (mm)	Throat Depth (T1) (mm)	Throat Width (mm)	Slot Orifice (mm)	Intake Area/ Metre (m ²)	Weight (kg)
CAT00001	100mm CastSlot Treadsafe - 3m	Up to F900	Concrete / Asphalt / Paving	3000		100	357	308	200	51	2 X 10	17467	44.7
CAT00002	150mm CastSlot Treadsafe - 3m	Up to F900	Concrete / Asphalt / Paving	3000		150	415	366	200	51	2 X 10	17467	51
CAT00003	225mm CastSlot Treadsafe - 3m	Up to F900	Concrete / Asphalt / Paving	3000		225	501	452	200	51	2 X 10	17467	61.1
CAT00004	300mm CastSlot Treadsafe - 3m	Up to F900	Concrete / Asphalt / Paving	3000		300	587	538	200	51	2 X 10	17467	70.3
CAT00005	350mm CastSlot Treadsafe - 3m	Up to F900	Concrete / Asphalt / Paving	3000		350	645	596	200	51	2 X 10	17467	76.6
CAT00006	400mm CastSlot Treadsafe - 3m	Up to F900	Concrete / Asphalt / Paving	3000		400	712	652	200	51	2 X 10	17467	126.2
CAT00007	500mm CastSlot Treadsafe - 3m	Up to F900	Concrete / Asphalt / Paving	3000		500	828	768	200	51	2 X 10	17467	146.9
CAT00008	600mm CastSlot Treadsafe - 3m	Up to F900	Concrete / Asphalt / Paving	3000		600	1091	1031	200	51	2 X 10	17467	216.6

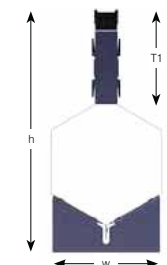

CastSlot Treadsafe 1m Channels



Code	Description	Load Rating	Surface Finish	Length (mm)		Width (w) (mm)	Height (h) (mm)	Invert (I) (mm)	Throat Depth (T1) (mm)	Throat Width (mm)	Slot Orifice (mm)	Intake Area/ Metre (m ²)	Weight (kg)
CAT00009	100mm CastSlot Treadsafe - 1m	Up to F900	Concrete / Asphalt / Paving	1000		100	357	308	200	51	2 X 10	17467	15.6
CAT00010	150mm CastSlot Treadsafe - 1m	Up to F900	Concrete / Asphalt / Paving	1000		150	415	366	200	51	2 X 10	17467	17.8
CAT00011	225mm CastSlot Treadsafe - 1m	Up to F900	Concrete / Asphalt / Paving	1000		225	501	452	200	51	2 X 10	17467	21.8
CAT00012	300mm CastSlot Treadsafe - 1m	Up to F900	Concrete / Asphalt / Paving	1000		300	587	538	200	51	2 X 10	17467	25
CAT00013	350mm CastSlot Treadsafe - 1m	Up to F900	Concrete / Asphalt / Paving	1000		350	645	596	200	51	2 X 10	17467	27.1
CAT00014	400mm CastSlot Treadsafe - 1m	Up to F900	Concrete / Asphalt / Paving	1000		400	712	652	200	51	2 X 10	17467	45.7
CAT00015	500mm CastSlot Treadsafe - 1m	Up to F900	Concrete / Asphalt / Paving	1000		500	828	768	200	51	2 X 10	17467	52.7
CAT00016	600mm CastSlot Treadsafe - 1m	Up to F900	Concrete / Asphalt / Paving	1000		600	1091	1031	200	51	2 X 10	17467	76

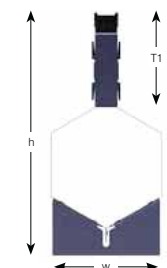

CastSlot Treadsafe 500mm Channels



Code	Description	Load Rating	Surface Finish	Length (mm)		Width (w) (mm)	Height (h) (mm)	Invert (I) (mm)	Throat Depth (T1) (mm)	Throat Width (mm)	Slot Orifice (mm)	Intake Area/ Metre (m ²)	Weight (kg)
CAT00017	100mm CastSlot Treadsafe - 500mm	Up to F900	Concrete / Asphalt / Paving	500		100	357	308	200	51	2 X 10	17467	8.4
CAT00018	150mm CastSlot Treadsafe - 500mm	Up to F900	Concrete / Asphalt / Paving	500		150	415	366	200	51	2 X 10	17467	9.5
CAT00019	225mm CastSlot Treadsafe - 500mm	Up to F900	Concrete / Asphalt / Paving	500		225	501	452	200	51	2 X 10	17467	12
CAT00020	300mm CastSlot Treadsafe - 500mm	Up to F900	Concrete / Asphalt / Paving	500		300	587	538	200	51	2 X 10	17467	13.7
CAT00021	350mm CastSlot Treadsafe - 500mm	Up to F900	Concrete / Asphalt / Paving	500		350	645	596	200	51	2 X 10	17467	14.8
CAT00022	400mm CastSlot Treadsafe - 500mm	Up to F900	Concrete / Asphalt / Paving	500		400	712	652	200	51	2 X 10	17467	25.5
CAT00023	500mm CastSlot Treadsafe - 500mm	Up to F900	Concrete / Asphalt / Paving	500		500	828	768	200	51	2 X 10	17467	29.1
CAT00024	600mm CastSlot Treadsafe - 500mm	Up to F900	Concrete / Asphalt / Paving	500		600	1091	1031	200	51	2 X 10	17467	40.9



CastSlot Treadsafe Drop Connectors



Code	Description		From Channel Width (mm)	To Channel Width (mm)	Weight (kg)
00155	100-150mm Drop Connector		100	150	0.4
00156	150-225mm Drop Connector		150	225	0.7
00157	225-300mm Drop Connector		225	300	1
00158	300-350mm Drop Connector		300	350	0.9
00159	350-400mm Drop Connector		350	400	1.7
00160	400-500mm Drop Connector		400	500	2.7
00161	500-600mm Drop Connector		500	600	5.9



Slotdrain product selector

Gatic UltraSlot



UltraSlot 3m Channels

Code	Description	Load Rating	Surface Finish	Length (mm)	Width (w) (mm)		Height (h) (mm)	Invert (i) (mm)	Throat Depth (T1) (mm)	Throat Width (mm)	Slot Orifice (mm)	Intake Area (mm²)	Weight (kg)
UA00025	100mm UltraSlot - 3m	Up to F900	Concrete	3000	100		357	308	200	70	30	30083	31.7
UA00026	150mm UltraSlot - 3m	Up to F900	Concrete	3000	150		415	366	200	70	30	30083	37.9
UA00027	225mm UltraSlot - 3m	Up to F900	Concrete	3000	225		501	452	200	70	30	30083	48.1
UA00028	300mm UltraSlot - 3m	Up to F900	Concrete	3000	300		587	538	200	70	30	30083	57.3
UA00029	350mm UltraSlot - 3m	Up to F900	Concrete	3000	350		645	596	200	70	30	30083	63.6
UA00030	400mm UltraSlot - 3m	Up to F900	Concrete	3000	400		713	653	200	70	30	30083	114.4
UA00031	500mm UltraSlot - 3m	Up to F900	Concrete	3000	500		829	769	200	70	30	30083	135
UA00032	600mm UltraSlot - 3m	Up to F900	Concrete	3000	600		1091	1031	200	70	30	30083	205.4

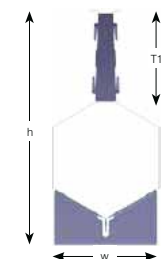

UltraSlot 1m Channels

Code	Description	Load Rating	Surface Finish	Length (mm)	Width (w) (mm)		Height (h) (mm)	Invert (i) (mm)	Throat Depth (T1) (mm)	Throat Width (mm)	Slot Orifice (mm)	Intake Area (mm²)	Weight (kg)
UA00033	100mm UltraSlot - 1m	Up to F900	Concrete	1000	100		357	308	200	70	30	30083	11.2
UA00034	150mm UltraSlot - 1m	Up to F900	Concrete	1000	150		415	366	200	70	30	30083	13.3
UA00035	225mm UltraSlot - 1m	Up to F900	Concrete	1000	225		501	452	200	70	30	30083	17.4
UA00036	300mm UltraSlot - 1m	Up to F900	Concrete	1000	300		587	538	200	70	30	30083	20.6
UA00037	350mm UltraSlot - 1m	Up to F900	Concrete	1000	350		645	596	200	70	30	30083	22.7
UA00038	400mm UltraSlot - 1m	Up to F900	Concrete	1000	400		713	653	200	70	30	30083	41.6
UA00039	500mm UltraSlot - 1m	Up to F900	Concrete	1000	500		829	769	200	70	30	30083	48.6
UA00040	600mm UltraSlot - 1m	Up to F900	Concrete	1000	600		1091	1031	200	70	30	30083	72.2

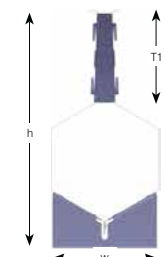

UltraSlot 500mm Channels

Code	Description	Load Rating	Surface Finish	Length (mm)	Width (w) (mm)		Height (h) (mm)	Invert (i) (mm)	Throat Depth (T1) (mm)	Throat Width (mm)	Slot Orifice (mm)	Intake Area (mm²)	Weight (kg)
UA00041	100mm UltraSlot - 500mm	Up to F900	Concrete	500	100		357	308	200	70	30	30083	6
UA00042	150mm UltraSlot - 500mm	Up to F900	Concrete	500	150		415	366	200	70	30	30083	7.1
UA00043	225mm UltraSlot - 500mm	Up to F900	Concrete	500	225		501	452	200	70	30	30083	9.7
UA00044	300mm UltraSlot - 500mm	Up to F900	Concrete	500	300		587	538	200	70	30	30083	11.3
UA00045	350mm UltraSlot - 500mm	Up to F900	Concrete	500	350		645	596	200	70	30	30083	12.4
UA00046	400mm UltraSlot - 500mm	Up to F900	Concrete	500	400		713	653	200	70	30	30083	23.4
UA00047	500mm UltraSlot - 500mm	Up to F900	Concrete	500	500		829	769	200	70	30	30083	27
UA00048	600mm UltraSlot - 500mm	Up to F900	Concrete	500	600		1091	1031	200	70	30	30083	38.8

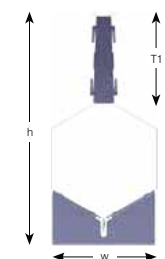

UltraSlot Drop Connectors

Code	Description		From Channel Width (mm)	To Channel Width (mm)	Weight (kg)
00155	100-150mm Drop Connector		100	150	0.4
00156	150-225mm Drop Connector		150	225	0.7
00157	225-300mm Drop Connector		225	300	1
00158	300-350mm Drop Connector		300	350	0.9
00159	350-400mm Drop Connector		350	400	1.7
00160	400-500mm Drop Connector		400	500	2.7
00161	500-600mm Drop Connector		500	600	5.9



Slotdrain product selector

Gatic UltraSlot Treadsafe



UltraSlot Treadsafe 3m Channels

Code	Description	Load Rating	Surface Finish	Length (mm)	Width (w) (mm)		Height (h) (mm)	Invert (i) (mm)	Throat Depth (T1) (mm)	Throat Width (mm)	Slot Orifice (mm)	Intake Area (mm ²)	Weight (kg)
UAT00025	100mm UltraSlot Treadsafe - 3m	Up to F900	Concrete	3000	100		357	308	200	70	2 X 9	18079	34.5
UAT00026	150mm UltraSlot Treadsafe - 3m	Up to F900	Concrete	3000	150		415	366	200	70	2 X 9	18079	40.7
UAT00027	225mm UltraSlot Treadsafe - 3m	Up to F900	Concrete	3000	225		501	452	200	70	2 X 9	18079	50.8
UAT00028	300mm UltraSlot Treadsafe - 3m	Up to F900	Concrete	3000	300		587	538	200	70	2 X 9	18079	60.1
UAT00029	350mm UltraSlot Treadsafe - 3m	Up to F900	Concrete	3000	350		645	596	200	70	2 X 9	18079	66.3
UAT00030	400mm UltraSlot Treadsafe - 3m	Up to F900	Concrete	3000	400		713	653	200	70	2 X 9	18079	117.1
UAT00031	500mm UltraSlot Treadsafe - 3m	Up to F900	Concrete	3000	500		829	769	200	70	2 X 9	18079	137.8
UAT00032	600mm UltraSlot Treadsafe - 3m	Up to F900	Concrete	3000	600		1091	1031	200	70	2 X 9	18079	208.2

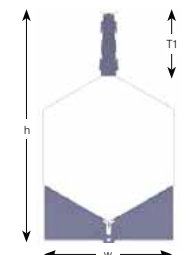

UltraSlot Treadsafe 1m Channels

Code	Description	Load Rating	Surface Finish	Length (mm)	Width (w) (mm)		Height (h) (mm)	Invert (i) (mm)	Throat Depth (T1) (mm)	Throat Width (mm)	Slot Orifice (mm)	Intake Area (mm ²)	Weight (kg)
UAT00033	100mm UltraSlot Treadsafe - 1m	Up to F900	Concrete	1000	100		357	308	200	70	2 X 9	18079	12.1
UAT00034	150mm UltraSlot Treadsafe - 1m	Up to F900	Concrete	1000	150		415	366	200	70	2 X 9	18079	14.2
UAT00035	225mm UltraSlot Treadsafe - 1m	Up to F900	Concrete	1000	225		501	452	200	70	2 X 9	18079	18.3
UAT00036	300mm UltraSlot Treadsafe - 1m	Up to F900	Concrete	1000	300		587	538	200	70	2 X 9	18079	21.5
UAT00037	350mm UltraSlot Treadsafe - 1m	Up to F900	Concrete	1000	350		645	596	200	70	2 X 9	18079	23.6
UAT00038	400mm UltraSlot Treadsafe - 1m	Up to F900	Concrete	1000	400		713	653	200	70	2 X 9	18079	42.6
UAT00039	500mm UltraSlot Treadsafe - 1m	Up to F900	Concrete	1000	500		829	769	200	70	2 X 9	18079	49.6
UAT00040	600mm UltraSlot Treadsafe - 1m	Up to F900	Concrete	1000	600		1091	1031	200	70	2 X 9	18079	73.1

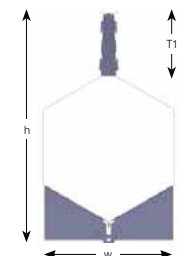

UltraSlot Treadsafe 500mm Channels

Code	Description	Load Rating	Surface Finish	Length (mm)	Width (w) (mm)		Height (h) (mm)	Invert (i) (mm)	Throat Depth (T1) (mm)	Throat Width (mm)	Slot Orifice (mm)	Intake Area (mm ²)	Weight (kg)
UAT00041	100mm UltraSlot Treadsafe - 500mm	Up to F900	Concrete	500	100		357	308	200	70	2 X 9	18079	6.4
UAT00042	150mm UltraSlot Treadsafe - 500mm	Up to F900	Concrete	500	150		415	366	200	70	2 X 9	18079	7.6
UAT00043	225mm UltraSlot Treadsafe - 500mm	Up to F900	Concrete	500	225		501	452	200	70	2 X 9	18079	10.1
UAT00044	300mm UltraSlot Treadsafe - 500mm	Up to F900	Concrete	500	300		587	538	200	70	2 X 9	18079	11.8
UAT00045	350mm UltraSlot Treadsafe - 500mm	Up to F900	Concrete	500	350		645	596	200	70	2 X 9	18079	12.9
UAT00046	400mm UltraSlot Treadsafe - 500mm	Up to F900	Concrete	500	400		713	653	200	70	2 X 9	18079	23.8
UAT00047	500mm UltraSlot Treadsafe - 500mm	Up to F900	Concrete	500	500		829	769	200	70	2 X 9	18079	27.4
UAT00048	600mm UltraSlot Treadsafe - 500mm	Up to F900	Concrete	500	600		1091	1031	200	70	2 X 9	18079	39.3

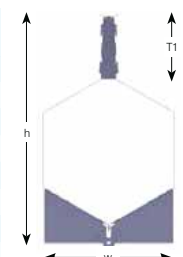

UltraSlot Treadsafe Drop Connectors

Code	Description		From Channel Width (mm)	To Channel Width (mm)	Weight (kg)
00155	100-150mm Drop Connector		100	150	0.4
00156	150-225mm Drop Connector		150	225	0.7
00157	225-300mm Drop Connector		225	300	1
00158	300-350mm Drop Connector		300	350	0.9
00159	350-400mm Drop Connector		350	400	1.7
00160	400-500mm Drop Connector		400	500	2.7
00161	500-600mm Drop Connector		500	600	5.9



Slotdrain product selector

Gatic PavSlot



PaveSlot 3m Channels

Code	Description	Load Rating	Surface Finish	Length (mm)	Width (w) (mm)		Height (h) (mm)	Invert (i) (mm)	Throat Depth (T1) (mm)	Throat Width (mm)	Slot Orifice (mm)	Intake Area/ Metre (m²)	Weight (kg)
PA00025	100mm PaveSlot - 3m	Up to C250	Paving	3000	100		357	308	200	16	10	10261	30.3
PA00026	150mm PaveSlot - 3m	Up to C250	Paving	3000	150		415	366	200	16	10	10261	36.5
PA00027	225mm PaveSlot - 3m	Up to C250	Paving	3000	225		501	452	200	16	10	10261	46.7
PA00028	300mm PaveSlot - 3m	Up to C250	Paving	3000	300		587	538	200	16	10	10261	55.9
PA00029	350mm PaveSlot - 3m	Up to C250	Paving	3000	350		645	596	200	16	10	10261	62.1
PA00192	400mm PaveSlot - 3m	Up to C250	Paving	3000	400		712	652	200	16	10	10261	111.9
PA00193	500mm PaveSlot - 3m	Up to C250	Paving	3000	500		828	768	200	16	10	10261	132.5
PA00194	600mm PaveSlot - 3m	Up to C250	Paving	3000	600		1091	1031	200	16	10	10261	202.8

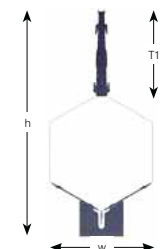

PaveSlot 1m Channels

Code	Description	Load Rating	Surface Finish	Length (mm)	Width (w) (mm)		Height (h) (mm)	Invert (i) (mm)	Throat Depth (T1) (mm)	Throat Width (mm)	Slot Orifice (mm)	Intake Area/ Metre (m²)	Weight (kg)
PA00033	100mm PaveSlot - 1m	Up to C250	Paving	1000	100		357	308	200	16	10	10261	10.7
PA00034	150mm PaveSlot - 1m	Up to C250	Paving	1000	150		415	366	200	16	10	10261	12.8
PA00035	225mm PaveSlot - 1m	Up to C250	Paving	1000	225		501	452	200	16	10	10261	16.9
PA00036	300mm PaveSlot - 1m	Up to C250	Paving	1000	300		587	538	200	16	10	10261	20
PA00037	350mm PaveSlot - 1m	Up to C250	Paving	1000	350		645	596	200	16	10	10261	22.2
PA00195	400mm PaveSlot - 1m	Up to C250	Paving	1000	400		712	652	200	16	10	10261	40.8
PA00196	500mm PaveSlot - 1m	Up to C250	Paving	1000	500		828	768	200	16	10	10261	47.8
PA00197	600mm PaveSlot - 1m	Up to C250	Paving	1000	600		1091	1031	200	16	10	10261	71.3

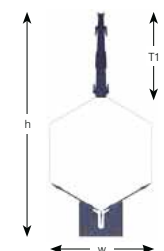

PaveSlot 500mm Channels

Code	Description	Load Rating	Surface Finish	Length (mm)	Width (w) (mm)		Height (h) (mm)	Invert (i) (mm)	Throat Depth (T1) (mm)	Throat Width (mm)	Slot Orifice (mm)	Intake Area/ Metre (m²)	Weight (kg)
PA00041	100mm PaveSlot - 500mm	Up to C250	Paving	500	100		357	308	200	16	10	10261	5.7
PA00042	150mm PaveSlot - 500mm	Up to C250	Paving	500	150		415	366	200	16	10	10261	6.8
PA00043	225mm PaveSlot - 500mm	Up to C250	Paving	500	225		501	452	200	16	10	10261	9.4
PA00044	300mm PaveSlot - 500mm	Up to C250	Paving	500	300		587	538	200	16	10	10261	11
PA00045	350mm PaveSlot - 500mm	Up to C250	Paving	500	350		645	596	200	16	10	10261	12.1
PA00198	400mm PaveSlot - 500mm	Up to C250	Paving	500	400		712	652	200	16	10	10261	22.9
PA00199	500mm PaveSlot - 500mm	Up to C250	Paving	500	500		828	768	200	16	10	10261	26.5
PA00200	600mm PaveSlot - 500mm	Up to C250	Paving	500	600		1091	1031	200	16	10	10261	38.3

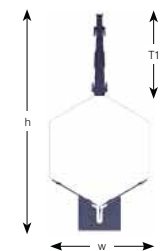

PaveSlot Drop Connectors

Code	Description		From Channel Width (mm)	To Channel Width (mm)	Weight (kg)
00155	100-150mm Drop Connector		100	150	0.4
00156	150-225mm Drop Connector		150	225	0.7
00157	225-300mm Drop Connector		225	300	1
00158	300-350mm Drop Connector		300	350	0.9
00159	350-400mm Drop Connector		350	400	1.7
00160	400-500mm Drop Connector		400	500	2.7
00161	500-600mm Drop Connector		500	600	5.9



Slotdrain product selector

Gatic FacadeSlot



FacadeSlot 3m Channels

Code	Description	Load Rating	Surface Finish	Length (mm)	Width (w) (mm)	Height (h) (mm)		Invert (I) (mm)	Throat Depth (T1) (mm)	Throat Width (mm)	Slot Orifice (mm)	Intake Area/Metre (mm²)	Weight (kg)
FA00025	50mm FacadeSlot - 3m	A15	Paving	3000	50	357		308	200	16	10	10470	28.2
FA00026	75mm FacadeSlot - 3m	A15	Paving	3000	75	415		366	200	16	10	10470	33.4
FA00027	115mm FacadeSlot - 3m	A15	Paving	3000	115	501		452	200	16	10	10470	41.5

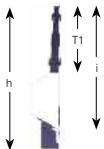

FacadeSlot 1m Channels

Code	Description	Load Rating	Surface Finish	Length (mm)	Width (w) (mm)	Height (h) (mm)		Invert (I) (mm)	Throat Depth (T1) (mm)	Throat Width (mm)	Slot Orifice (mm)	Intake Area/Metre (mm²)	Weight (kg)
FA00033	50mm FacadeSlot - 1m	A15	Paving	1000	50	357		308	200	16	10	10470	9.8
FA00034	75mm FacadeSlot - 1m	A15	Paving	1000	75	415		366	200	16	10	10470	11.6
FA00035	115mm FacadeSlot - 1m	A15	Paving	1000	115	501		452	200	16	10	10470	14.6

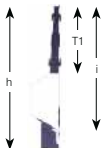

FacadeSlot 500mm Channels

Code	Description	Load Rating	Surface Finish	Length (mm)	Width (w) (mm)	Height (h) (mm)		Invert (I) (mm)	Throat Depth (T1) (mm)	Throat Width (mm)	Slot Orifice (mm)	Intake Area/Metre (mm²)	Weight (kg)
FA00041	50mm FacadeSlot - 500mm	A15	Paving	500	50	357		308	200	16	10	10470	5.1
FA00042	75mm FacadeSlot - 500mm	A15	Paving	500	75	415		366	200	16	10	10470	6.1
FA00043	115mm FacadeSlot - 500mm	A15	Paving	500	115	501		452	200	16	10	10470	7.8

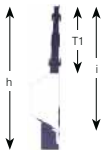

FacadeSlot System End Caps

Code	Description		To suit channel widths	Weight (kg)
00170	FacadeSlot End Cap 50mm		50mm	0.1
00171	FacadeSlot End Cap 75mm		75mm	0.2
00172	FacadeSlot End Cap 115mm		115mm	0.4



Slotdrain product selector

Boxes



Access Box C/W Treadsafe Double Triangular Grating (CastSlot/UltraSlot)

Code	Description	To Suit Channels	Load Rating	Surface Finish		Height (h) (mm)	Width (w) (mm)	Depth (d) (mm)	Intake Area (mm ²)	Pipe Outlet Sizes (mm)	Box Weight (kg)	Cover/Grate Weight (kg)	Total Weight (kg)
ADD00116	Access Box c/w Double Triangular Grating	Up to 225	Up to D400	Asphalt / Paving		475	308	308	9008	N/A	6.7	38.4	45.1
ADD00119	Access Box c/w Double Triangular Grating	From 225 to 400	Up to D400	Asphalt / Paving		675	485	485	33486	N/A	26.7	67.6	94.3
ADD00122	Access Box c/w Double Triangular Grating	From 400 to 600	Up to D400	Asphalt / Paving		1055	686	686	82845	N/A	73.1	122.9	196.1
ADF00118	Access Box c/w Double Triangular Grating	Up to 225	Up to F900	Concrete		475	308	308	9008	N/A	6.7	40.1	46.8
ADF00121	Access Box c/w Double Triangular Grating	From 225 to 400	Up to F900	Concrete		675	485	485	33486	N/A	26.7	76.7	103.4
ADF00124	Access Box c/w Double Triangular Grating	From 400 to 600	Up to F900	Concrete		1055	686	686	82845	N/A	73.1	146.2	219.3

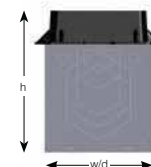

Outlet Box C/W Treadsafe Double Triangular Grating (CastSlot/UltraSlot)

Code	Description	To Suit Channels	Load Rating	Surface Finish		Height (h) (mm)	Width (w) (mm)	Depth (d) (mm)	Intake Area (mm ²)	Pipe Outlet Sizes (mm)	Box Weight (kg)	Cover/Grate Weight (kg)	Total Weight (kg)
TDD00116	Outlet Box c/w Double Triangular Grating	Up to 225	Up to D400	Asphalt / Paving		740	308	308	9008	115/ 165/ 205/ 255	10.6	38.4	49.1
TDD00119	Outlet Box c/w Double Triangular Grating	From 225 to 400	Up to D400	Asphalt / Paving		1125	485	485	33486	205/ 255/ 320/ 360/ 440	44	67.6	111.6
TDD00122	Outlet Box c/w Double Triangular Grating	From 400 to 600	Up to D400	Asphalt / Paving		1495	686	686	82845	320/ 360/ 440	101.7	122.9	224.7
TDF00118	Outlet Box c/w Double Triangular Grating	Up to 225	Up to F900	Concrete		740	308	308	9008	115/ 165/ 205/ 255	10.6	40.1	50.7
TDF00121	Outlet Box c/w Double Triangular Grating	From 225 to 400	Up to F900	Concrete		1125	485	485	33486	205/ 255/ 320/ 360/ 440	44	76.7	120.7
TDF00124	Outlet Box c/w Double Triangular Grating	From 400 to 600	Up to F900	Concrete		1495	686	686	82845	320/ 360/ 440	101.7	146.2	247.9

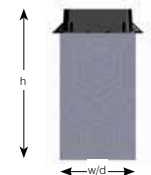

Silt Box C/W Treadsafe Double Triangular Grating (CastSlot/UltraSlot)

Code	Description	To Suit Channels	Load Rating	Surface Finish		Height (h) (mm)	Width (w) (mm)	Depth (d) (mm)	Intake Area (mm ²)	Pipe Outlet Sizes (mm)	Box Weight (kg)	Cover/Grate Weight (kg)	Total Weight (kg)
SDD00116	Silt Box c/w Double Triangular Grating	Up to 225	Up to D400	Asphalt / Paving		930	308	308	9008	115/ 165/ 205/ 255	14.1	38.4	55.3
SDD00119	Silt Box c/w Double Triangular Grating	From 225 to 400	Up to D400	Asphalt / Paving		1415	485	485	33486	205/ 255/ 320/ 360/ 440	57.1	67.6	136.5
SDD00122	Silt Box c/w Double Triangular Grating	From 400 to 600	Up to D400	Asphalt / Paving		1935	686	686	82845	320/ 360/ 440	133.8	122.9	287.8
SDF00118	Silt Box c/w Double Triangular Grating	Up to 225	Up to F900	Concrete		930	308	308	9008	115/ 165/ 205/ 255	14.1	40.1	55.3
SDF00121	Silt Box c/w Double Triangular Grating	From 225 to 400	Up to F900	Concrete		1415	485	485	33486	205/ 255/ 320/ 360/ 440	57.1	76.7	145.6
SDF00124	Silt Box c/w Double Triangular Grating	From 400 to 600	Up to F900	Concrete		1935	686	686	82845	320/ 360/ 440	133.8	146.2	311

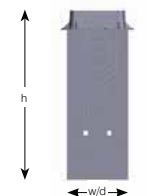

Access Box C/W Galvanised Recessed Cover (PaveSlot)

Code	Description	To Suit Channels	Load Rating	Surface Finish		Height (h) (mm)	Width (w) (mm)	Depth (d) (mm)	Intake Area (mm ²)	Pipe Outlet Sizes (mm)	Box Weight (kg)	Cover/Grate Weight (kg)	Total Weight (kg)
AFC00125	Access Box c/w Galvanised Recessed Cover	Up to 225	Up to C250	Paving		475	308	308	2710	N/A	6.7	28.7	35.4
AFC00127	Access Box c/w Galvanised Recessed Cover	From 225 to 400	Up to C250	Paving		675	485	485	4460	N/A	26.7	50.5	77.2
AFC00129	Access Box c/w Galvanised Recessed Cover	From 400 to 600	Up to C250	Paving		1055	686	686	6460	N/A	73.1	78	151.1

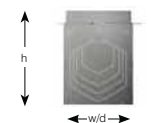

Outlet Box C/W Galvanised Recessed Cover (PaveSlot)

Code	Description	To Suit Channels	Load Rating	Surface Finish		Height (h) (mm)	Width (w) (mm)	Depth (d) (mm)	Intake Area (mm ²)	Pipe Outlet Sizes (mm)	Box Weight (kg)	Cover/Grate Weight (kg)	Total Weight (kg)
TFC00125	Outlet Box c/w Galvanised Recessed Cover	UP TO 225	UP TO C250	Paving		740	308	308	2710	115/ 165/ 205/ 255	10.6	28.7	39.3
TFC00127	Outlet Box c/w Galvanised Recessed Cover	FROM 225 TO 400	UP TO C250	Paving		1125	485	485	4460	205/ 255/ 320/ 360/ 440	44	50.5	94.5
TFC00129	Outlet Box c/w Galvanised Recessed Cover	FROM 400 TO 600	UP TO C250	Paving		1495	686	686	6460	320/ 360/ 440	101.7	78	179.7

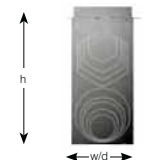

Slotdrain product selector

Boxes



Silt Box C/W Galvanised Recessed Cover (PaveSlot)

Code	Description	To Suit Channels	Load Rating	Surface Finish		Height (h) (mm)	Width (w) (mm)	Depth (d) (mm)	Intake Area (mm²)	Pipe Outlet Sizes (mm)	Box Weight (kg)	Cover/Grate Weight (kg)	Total Weight (kg)
SFC00125	Silt Box c/w Galvanised Recessed Cover	Up to 225	Up to C250	Paving		930	308	308	2710	115/ 165/ 205/ 255	14.1	28.7	45.4
SFC00127	Silt Box c/w Galvanised Recessed Cover	From 225 To 400	Up to C250	Paving		1415	485	485	4460	205/ 255/ 320/ 360/ 440	57.1	50.5	119.4
SFC00129	Silt Box c/w Galvanised Recessed Cover	From 400 To 600	Up to C250	Paving		1935	686	686	6460	320/ 360/ 440	133.8	78	242.8



Façade Access Box C/W Galvanised Recessed Covers (FaçadeSlot)

Code	Description	To Suit Channels	Load Rating	Surface Finish		Height (h) (mm)	Width (w) (mm)	Depth (d) (mm)	Intake Area (mm²)	Pipe Outlet Sizes (mm)	Box Weight (kg)	Cover/Grate Weight (kg)	Total Weight (kg)
FBA00140	Façade Access Box c/w Galvanised Recessed Cover	115	A15	Paving		475	253	253	N/A	N/A	7.1	2.5	9.8

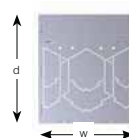

Façade Outlet Box C/W Galvanised Recessed Covers (FaçadeSlot)

Code	Description	To Suit Channels	Load Rating	Surface Finish		Height (h) (mm)	Width (w) (mm)	Depth (d) (mm)	Intake Area (mm²)	Pipe Outlet Sizes (mm)	Box Weight (kg)	Cover/Grate Weight (kg)	Total Weight (kg)
FBA00144	Façade Outlet Box c/w Galvanised Recessed Cover	115	A15	Paving		675	253	253	N/A	115, 165, 205	9.5	2.5	12.2

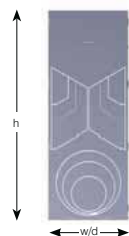

Façade Combined Access/Outlet VBox (FaçadeSlot)

Code	Description	To Suit Channels	Load Rating	Surface Finish		Height (h) (mm)	Width (w) (mm)	Depth (d) (mm)	Intake Area (mm²)	Pipe Outlet Sizes (mm)	Box Weight (kg)	Cover/Grate Weight (kg)	Total Weight (kg)
FBA00146	Façade Combined Access / Outlet Box	115	A15	Paving		575	168	333	7511	115, 165, 250	N/A	N/A	9.9

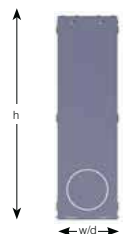

Slotdrain product selector

Catchpit Connectors, Pipes, End Caps & Outlets

CastSlot / CastSlot Treadsafe / UltraSlot / UltraSlot Treadsafe / PaveSlot
Catchpit Connector

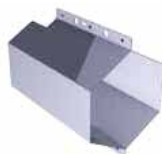

Code	Description	To Suit Channel	Length (mm)	Effective Length (mm)	Weight (kg)
CCA00173	100mm Catchpit Connector	100	375	300	1.9
CCA00174	150mm Catchpit Connector	150	375	300	2.6
CCA00175	225mm Catchpit Connector	225	375	300	3.9
CCA00176	300mm Catchpit Connector	300	375	300	5
CCA00177	350mm Catchpit Connector	350	375	300	5.8
CCA00178	400mm Catchpit Connector	400	375	300	10.9
CCA00179	500mm Catchpit Connector	500	375	300	13.5
CCA00180	600mm Catchpit Connector	600	375	300	21.9

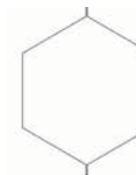

CastSlot / CastSlot Treadsafe / UltraSlot / UltraSlot Treadsafe / PaveSlot
Channel Pipes



Code	Description	To Suit Channel	Length (mm)	Weight (kg)
SPA00181	100mm Channel Pipe – 3m	100	3000	17.1
SPA00182	150mm Channel Pipe – 3m	150	3000	23.3
SPA00183	225mm Channel Pipe – 3m	225	3000	33.5
SPA00184	300mm Channel Pipe – 3m	300	3000	42.7
SPA00185	350mm Channel Pipe – 3m	350	3000	49
SPA00186	400mm Channel Pipe – 3m	400	3000	91.4
SPA00187	500mm Channel Pipe – 3m	500	3000	112
SPA00188	600mm Channel Pipe – 3m	600	3000	178.6



CastSlot / CastSlot Treadsafe / UltraSlot / UltraSlot Treadsafe /
PaveSlot / FacadeSlot End Caps / End Cap Outlets



Code	Description	To Suit Channel	Pipe Outlet Sizes (mm)	Weight (kg)
00162	100mm End Cap / Outlet	100	92	0.2
00163	150mm End Cap / Outlet	150	115	0.4
00164	225mm End Cap / Outlet	225	115/165/205	0.7
00165	300mm End Cap / Outlet	300	115/165/205/255	1.2
00166	350mm End Cap / Outlet	350	115/165/205/255/320	1.6
00167	400mm End Cap / Outlet	400	115/165/205/255/320/360	3.3
00168	500mm End Cap	500	N/A	4.9
00169	600mm End Cap	600	N/A	10.6
00170	FacadeSlot End Cap 50mm	50	N/A	0.1
00171	FacadeSlot End Cap 75mm	75	N/A	0.2
00172	FacadeSlot End Cap 115mm	115	N/A	0.4



Gatic Flow Regulators



Available for all Slotdrain except FacadeSlot
(for use with Chambers formed on site)

Code	Description	To Suit Channel	Height (h)	Width (w)	Weight (kg)
00217	225mm Flow Regulator	225	295	275	1.9
00218	300mm Flow Regulator	300	380	350	3.1
00219	350mm Flow Regulator	350	440	400	4.1
00220	400mm Flow Regulator	400	495	450	5.4
00221	500mm Flow Regulator	500	610	550	8.1
00222	600mm Flow Regulator	600	875	650	13.7

*Outlet size made to order on all Flow Regulators

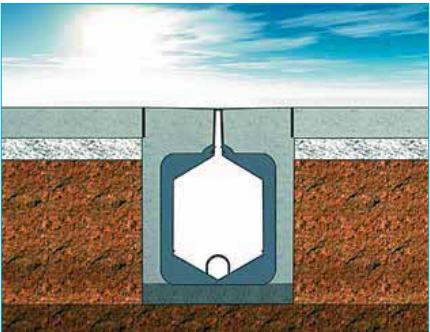
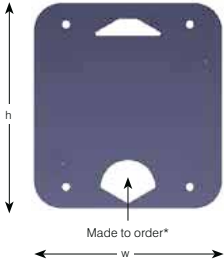

Dry weather conditions.

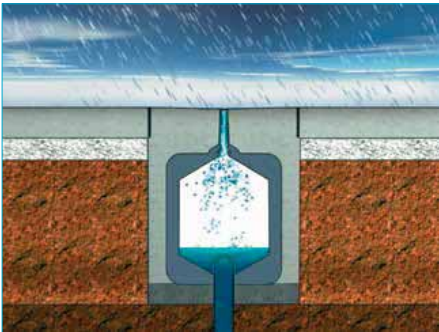

Rainfall starts, the Slotdrain begins to fill with water and discharges via the flow regulator.

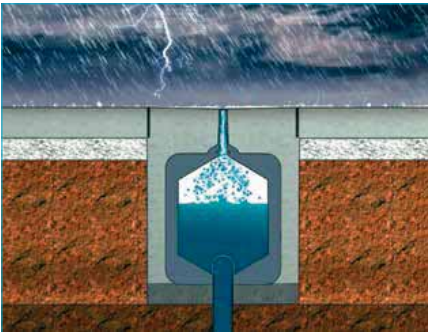

Water level in the Slotdrain system rises with storm intensity. Outflow reaches designed regulated flow rate without flooding surrounding area.

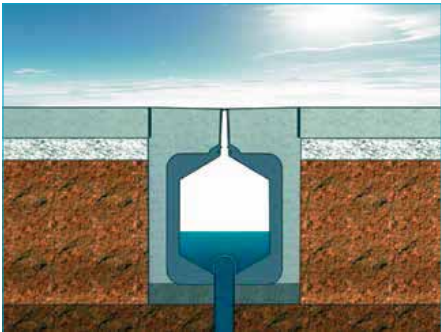

Storm ceases, controlled outflow continues and water level in the Slotdrain system falls.



Filcoten®

Overview

Filcoten is an innovative, lightweight concrete channel drainage system that sets new standards in strength, installed performance and environmental benefits. The unique combination of high strength, high durability and geometric stability provides engineers and contractors with a market leading channel drainage solution.

High Performance Concrete

Filcoten is a significant advance in the formulation and manufacture of High Performance Concrete (HPC) products.

HPC represents compressive (load bearing) strength, which is generally measured in Newtons/mm sq. If a concrete product achieves a compressive strength of 50 N/mm sq or above it is classified as an HPC product.

HPC was originally developed for use on large civil engineering structures. This is because it was difficult to control the manufacturing process and achieve consistent results for smaller scale solutions, like channel drainage.

However, due to the unique composition of Filcoten, the control of manufacture and the curing process it achieves an outstanding compressive strength of 80-90 N/mm sq, making it a leading HPC solution for commercial and domestic projects.

Flexural Strength

In addition to Filcoten's compressive strength, it also achieves a high level of flexural strength – approximately double that of conventional HPC. The combination of compressive and flexural strength is what sets Filcoten apart from other traditional channel drainage products.

Flexural strength is defined as a material's ability to resist deformation under loads. With conventional HPC the product would simply shatter and break under a sudden load or with sudden impact.

Filcoten's flexural strength means it can flex and absorb shock loads and sudden impacts. This has benefits in transit, in handling, and in stock too, with far fewer breakages. The robustness of Filcoten translates into considerably longer and trouble-free operational life, as well as substantial cost savings over the product lifetime.



Filcoten Self



Filcoten Pave



Filcoten Pro G



Filcoten Tec NW100 channel

Sustainable

Uniquely, Filcoten is manufactured without the use of chemicals. It is the only product to be made using mineral fibres, small mineral particles and renewable energy. It's also 100% recyclable.

Easy to install and great looks

Filcoten's dense micro-structure means a better looking product, with a smoother and sleeker wall finish. It is also more consistent dimensionally, which improves the accuracy of the installation. Its lightweight composition makes it easier to install.

When installed Filcoten won't crack easily or become separated from its concrete surround with temperature changes. It is designed to endure frost/thaw cycling conditions and will expand and contract at the same rate, resisting crack formation, water penetration and the process of breakdown.

Secure

Filcoten comes with a four point locking system every half metre, so the grating stays securely in place under heavy traffic loading. It is also available with an anti-vandal locking device to deter thieves and comes fitted with two anti-slide lugs to secure the grating against any longitudinal shifting.

Filcoten is available in five ranges: Pro, Tec, Self, Pave and Green.

Site Work and Maintenance Guide

Visit our website www.gatic.com for general information on safe handling, installation and maintenance of our products.

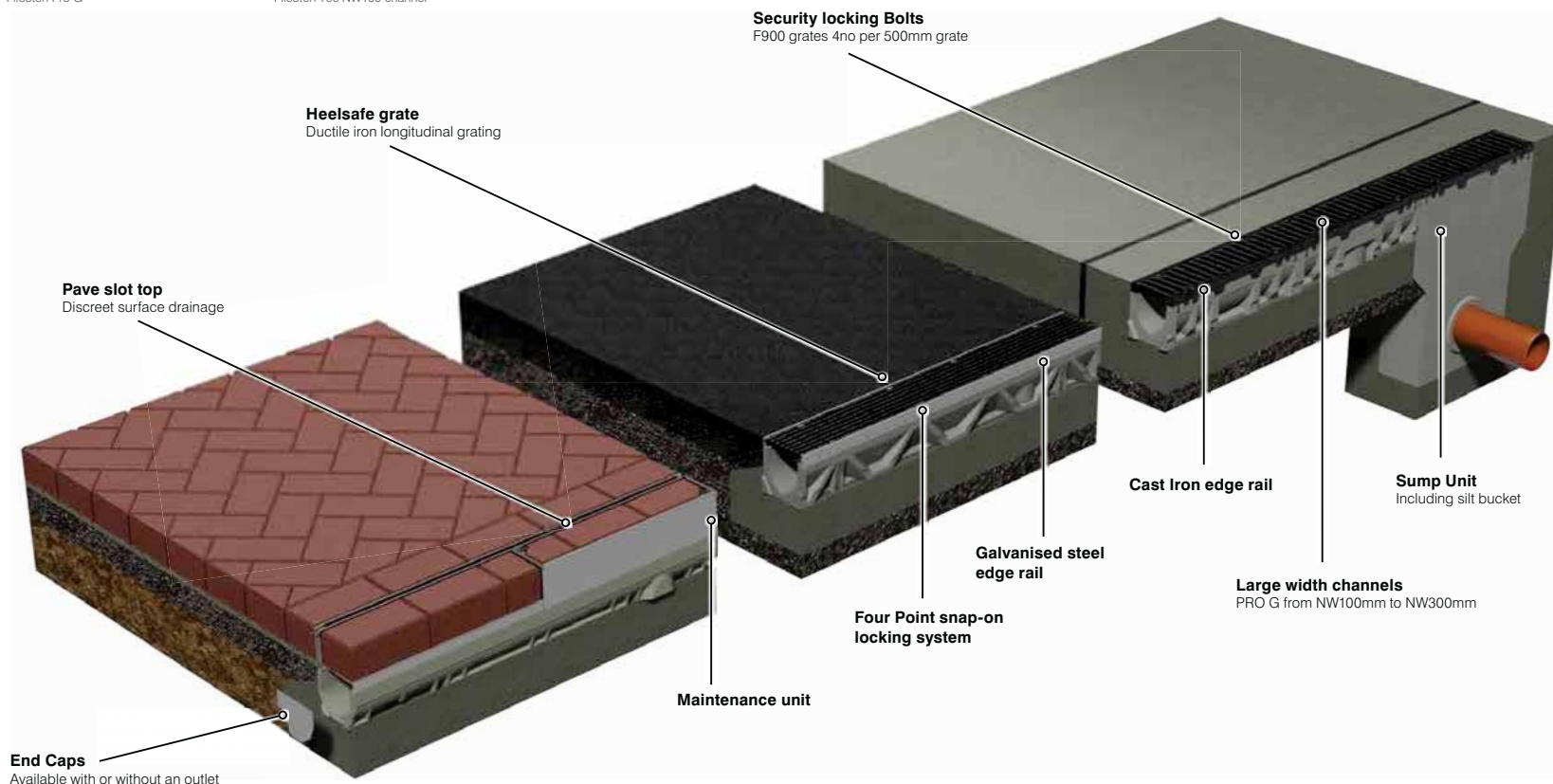

Filcoten product selector

Filcoten Pro

Available with integral rails made in either cast iron (Pro G) or galvanised steel (Pro V). The innovative production and moulding technology, and anchoring ribs ensure a secure bonding with the surrounding concrete bed.

Filcoten Pro is primarily suited for commercial areas such as factories, warehouse facilities and car parks, but can also be used for public facilities such as train stations or for residential applications.

Pro G

Channel bodies with Cast Iron edge rails NW100mm, 150mm, 200mm & 300mm.

Heelsafe bar, slotted and mesh grating options available with a simple four point snap-on locking device. F900 grates come with security locking bolts.

Load Classification D400 to F900.



Applications:

- Highways and Motorways
- Distribution Yards and Industrial Units
- Petrol Stations and Forecourts
- Bus Terminals
- Container Ports and Distribution Yards



As part of the Pro range, Pro G is ideal for use on demanding projects.



Areas which combine high pedestrian and vehicular traffic are perfect for Filcoten Pro G.



Filcoten Pro G mini channel available in NW100/150/200/300



Filcoten Pro V is well suited to commercial areas.



Also available as Filcoten pro V mini

Pro V

Channel bodies with galvanised steel edge rails NW100mm, 150mm, 200mm and 300mm.

Heelsafe bar, slotted and mesh grating options available with a simple four point snap-on locking device.

Load Classification C250 to E600



Applications:

- Car Parks
- Highways and Motorways
- Distribution Yards and Industrial Units
- Shopping Centres and Retail Parks
- Petrol Stations and Forecourts
- Bus Terminals
- Container Ports and Distribution Yards

Filcoten product selector

Filcoten Tec

Tec offers the superior benefits of Filcoten with additional safety aspects. It is ideal for pedestrian areas, car parks, shopping centres and similar applications.

The galvanised steel rails are designed with a snap-on locking system for a secure grating.

Ductile iron longitudinal grating with a four point snap-on locking system.

Tec is also available in a shallow channel.

Channel bodies with level invert in nominal width of 100mm (other widths available).

Complete system with sump units and end caps.

Load Classification C250 to D400



Applications:

- Landscaping and Pedestrian Schemes
- Car Parks
- Shopping Centres and Retail Parks



Tec channel with heelsafe grating



Pedestrian areas benefit from Filcoten Tec's efficient water drainage



Filcoten Tec is suitable for pedestrian areas, such as public walkways



Filcoten Self is ideal for areas of low vehicular traffic



Filcoten Self

Filcoten Self is an incredibly light and easy-to-move drainage channel, used primarily for domestic new build and other domestic applications such as drives and gardens.

Slotted gratings made of galvanised steel and ductile iron gratings with a snap-on locking system.

Channel body with level invert in nominal width of 100mm.

Load classification A15 to B125



Applications:

- Landscaping and Pedestrian Schemes
- Low traffic Car Parks

Filcoten product selector

Filcoten Pave

Pave is part of the Filcoten Self channel range. It offers a discreet slot top finish suitable for concrete blocks or pavers up to 80mm in depth.

Pave is ideal for domestic new builds and other domestic applications such as landscaping projects, terraces, balconies and driveways.

The offset draining slot of Pave ensures a subtle threshold drainage solution, with slotted tops and access units manufactured from galvanised steel.

Its lightweight structure makes it easy to move on site, but without compromising on quality or performance.

Channel body with level invert in nominal width of 100mm. Complete with a pave slot top.

Load classification A15 to B125.



Applications:

- Landscaping and Pedestrian Schemes
- Driveways and Private Car Parks

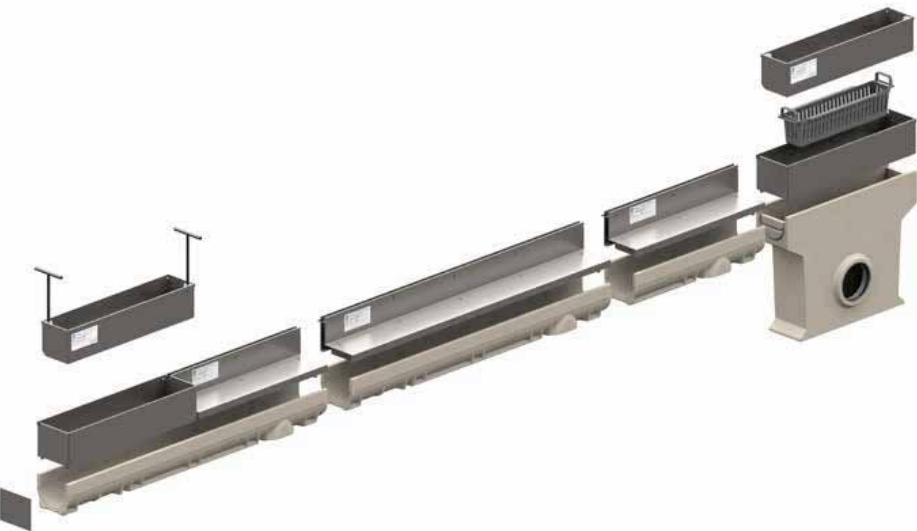

Filcoten product selector

Filcoten Accessories & Gratings

Filcoten comes with a comprehensive range of accessories and grating options to suit every channel within the range. The images below are representative.

Visit www.gatic.com for more information or call our technical team on 01304 203545 to help you specify the best solutions for your project.



Simple and secure: the four-point snap on locking system.

The gratings are initially inserted on one side of the channel. They are locked by means of a simple turning of the grate. For both galvanised and ductile iron gratings.

Accessories



Sump Units



Silt Baskets

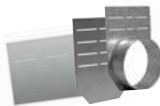

End Caps/Outlets



Bottom Outlet



Locking Devices

Filcoten Gratings

Filcoten PRO



Mesh Grating (MW 25/10)



Mesh Grating (MW 30/10)



NEW COMBee Design Composite Grating



Ductile Iron Elongated Bar Grating (MW 29/13)



Ductile Iron Elongated Bar (MW 22/13)



Ductile Iron slotted Grating (SW 14/100, 14/150, 14/200)

Filcoten TEC



Galvanised Slotted Grating



Mesh Grating Galvanised Steel



Ductile Iron Bar Heelsafe Grating

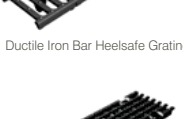

Ductile Iron Elongated Bar

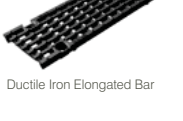

NEW COMBee Design Composite Grating

Filcoten SELF



Ductile Iron Grating



Slotted Heelsafe Grating

Filcoten PAVE



Pave Top

Filcoten product selector

Filcoten Green

Filcoten Green filters organic and inorganic impurities out of rainwater before they re-enter the watercourse. It offers sustainable protection for groundwater and soil.

Key benefits:

- Holds back 99% of heavy metals, organic substances and particles
- Oil residues are broken down biologically
- Reduces pollutant load for sewage plant
- Suited to integrate in sewage water network
- Can be inspected and cleaned
- Easy maintenance and replacement of the substrate agent
- Low investment and low follow-on costs
- Resilient up to Class E600
- 20 years' service life

Grates

A selection of galvanised steel mesh gratings and ductile iron gratings are available. The gratings are available with bolted locking or with fix self-locking system.

Adapter front cap

This separation cap is the final part in the substrate area of the channel, therefore preventing the substrate from reaching the sump unit.

Vertical outlet

For waterproof closure of the channel. Available with horizontal outlet connection or closed endcap.

End cap

For waterproof closure of the channel. Available with horizontal outlet connection or closed endcap.

The technology behind it

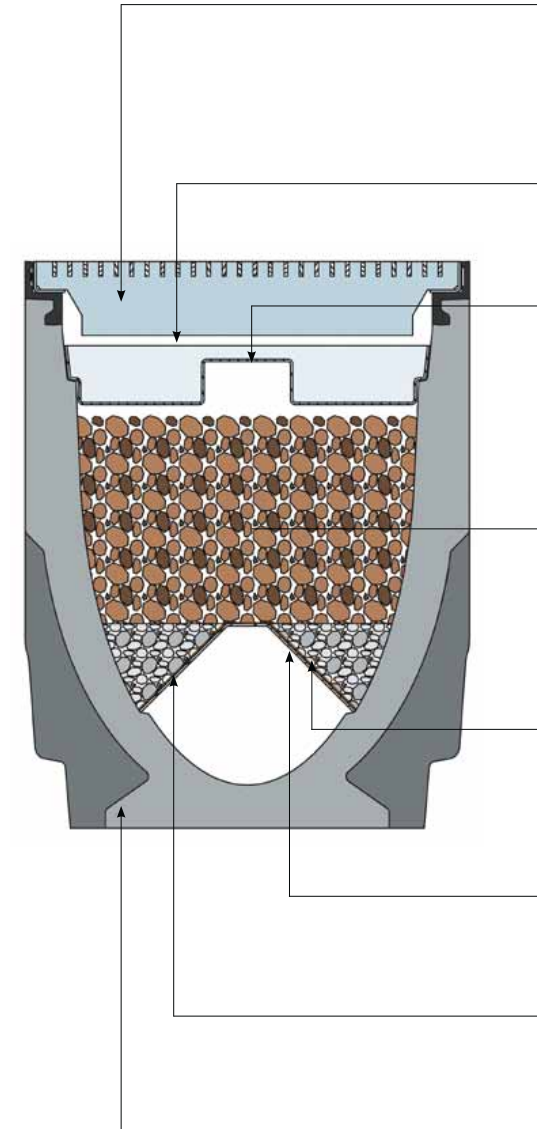

1) Mesh gratings made of galvanised steel or ductile iron longitudinal bar gratings NW300, resilient up to class E600

The rainwater polluted with fine and coarse dirt comes into contact with the channel for the first time. Oversized dirt particles are mechanically stopped by the grate.

2) Reservoir for surface water

If there is heavy rainfall, excess surface water can be collected here and is only fed into the cleaning system gradually.

3) Coarse dirt sedimentation level

Coarse dirt which makes it through the grate is mechanically held back by this sedimentation unit. The hydraulically optimised overflow of the sedimentation level sits in a central location, achieving an optimal, even distribution of the feed-in medium above the substrate zone. The level of effectiveness is increased considerably.

4) First substrate layer: ENREGIS/Cleancalith A

This natural mineral mixture filters organic dirt loads from the polluted rainwater. It reduces the proportion of particulate, particle-bonded and dissolved substances through filtration, absorption, degradation, precipitation and complexation.

5) Second substrate layer: ENREGIS/Cleancalith B

Heavy metals and other inorganic compounds are removed or held back by this synthetic granulate. It is environmentally sound to an unlimited extent.

6) Hydraulic separating fabric

This material holds residual fine substances back, preventing them from getting through the underlying spacers in the flow area.

7) Trapezoidal spacers

These separate the substrate zone from the flow area, thereby creating a permanently free cross section in the channel.

8) Extremely stable channel bodies made of Filcoten

The unique material Filcoten is both extremely impact resistant and environmentally friendly.

Filcoten product selector

Filcoten Pro G



FILCOTEN PRO G Channel NW100 Cast Iron Edge, without slope

Code	Description		Load rating	Length (mm)	Width (w) mm	Height (h) (mm)	Invert (i) (mm)	Weight (kg)
10610100	FILCOTEN PRO G NW100 Nr. 0, without slope		F900	1000	138	142	95	19.1
10610161	FILCOTEN PRO G NW100 Nr. 5-0, without slope		F900	1000	138	170	125	22.6
10610162	FILCOTEN PRO G NW100 Nr. 10-0, without slope		F900	1000	138	195	150	26.1
10610164	FILCOTEN PRO G NW100 Nr. 20-0, without slope		F900	1000	138	245	200	26.9
10610180	FILCOTEN PRO G NW100 Nr. 0, L=500mm, without slope		F900	500	138	142	95	9.7
10610181	FILCOTEN PRO G NW100 Nr. 5-0, L=500mm, without slope		F900	500	138	170	125	11.5
10610182	FILCOTEN PRO G NW100 Nr. 10-0, L=500mm, without slope		F900	500	138	195	150	13.6
10610184	FILCOTEN PRO G NW100 Nr. 20-0, L=500mm, without slope		F900	500	138	245	200	15



Filcoten®



FILCOTEN PRO G Channel NW150 Cast Iron Edge, without slope

Code	Description		Load rating	Length (mm)	Width (w) mm	Height (h) (mm)	Invert (i) (mm)	Weight (kg)
10615100	FILCOTEN PRO G NW150 Nr. 0, without slope		F900	1000	188	210	165	31.1
10615161	FILCOTEN PRO G NW150 Nr. 5-0, without slope		F900	1000	188	235	190	35.2
10615162	FILCOTEN PRO G NW150 Nr. 10-0, without slope		F900	1000	188	260	215	39.2
10615164	FILCOTEN PRO G NW150 Nr. 20-0, without slope		F900	1000	188	310	265	47.8
10615180	FILCOTEN PRO G NW150 Nr. 0, L=500mm, without slope		F900	500	188	210	165	15.7
10615181	FILCOTEN PRO G NW150 Nr. 5-0, L=500mm, without slope		F900	500	188	235	190	19.8
10615182	FILCOTEN PRO G NW150 Nr. 10-0, L=500mm, without slope		F900	500	188	260	215	20.2
10615184	FILCOTEN PRO G NW150 Nr. 20-0, L=500mm, without slope		F900	500	188	310	265	23.9

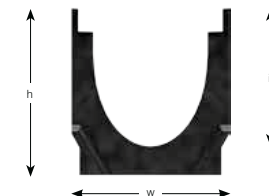

FILCOTEN PRO G Channel NW200 Cast Iron Edge, without slope

Code	Description		Load rating	Length (mm)	Width (w) mm	Height (h) (mm)	Invert (i) (mm)	Weight (kg)
10620100	FILCOTEN PRO G NW200 Nr. 0, without slope		F900	1000	238	265	2220	44.8
10620161	FILCOTEN PRO G NW200 Nr. 5-0, without slope		F900	1000	238	290	245	49.8
10620162	FILCOTEN PRO G NW200 Nr. 10-0, without slope		F900	1000	238	315	270	54.8
10620164	FILCOTEN PRO G NW200 Nr. 20-0, without slope		F900	1000	238	365	320	63.6
10620180	FILCOTEN PRO G NW200 Nr. 0, L=500mm, without slope		F900	500	238	265	220	22.6
10620181	FILCOTEN PRO G NW200 Nr. 5-0, L=500mm, without slope		F900	500	238	290	245	24.9
10620182	FILCOTEN PRO G NW200 Nr. 10-0, L=500mm, without slope		F900	500	238	315	270	27.4
10620184	FILCOTEN PRO G NW200 Nr. 20-0, L=500mm, without slope		F900	500	238	365	320	31.8



FILCOTEN PRO G Channel NW300 Cast Iron Edge, without slope

Code	Description		Load rating	Length (mm)	Width (w) mm	Height (h) (mm)	Invert (i) (mm)	Weight (kg)
10630100	FILCOTEN PRO G NW300 Nr. 0, without slope		F900	1000	360	360	305	77.3
10630162	FILCOTEN PRO G NW300 Nr. 10-0, without slope		F900	1000	360	410	355	90.3
10630164	FILCOTEN PRO G NW300 Nr. 20-0, without slope		F900	1000	360	460	405	110.7
10630180	FILCOTEN PRO G NW300 Nr. 0, L=500mm, without slope		F900	500	360	360	305	38.8



Filcoten product selector

Filcoten Pro G



PRO G NW100 - Gratings

Code	Description		Load rating	Length (mm)	Width (mm)	Depth (mm)	Weight (kg)
17010103A	FILCOTEN PRO G ductile iron bar grating NW100, MW 22/13, cl. Inc Bolts		E600	500	122	20	4.2
17010107A	FILCOTEN PRO G ductile iron slotted grating NW100, SW 14/100, Inc Bolts		F900	500	122	20	4.8



PRO G NW150 - Gratings

Code	Description		Load rating	Length (mm)	Width (mm)	Depth (mm)	Weight (kg)
17015103A	FILCOTEN PRO G ductile iron bar grating NW150, MW 22/13, Inc Bolts		E600	500	122	20	7.2
17015107A	FILCOTEN PRO G ductile iron slotted grating NW150, SW 14/150, Inc Bolts		F900	500	122	20	7.3



PRO G NW200 - Gratings

Code	Description		Load rating	Length (mm)	Width (mm)	Depth (mm)	Weight (kg)
17020103A	FILCOTEN PRO ductile iron bar grating NW200, MW 22/13, Inc Bolts		E600	500	222	20	8.8
17020107A	FILCOTEN PRO ductile iron slotted grating NW200, SW 14/95, Inc Bolts		F900	500	222	20	12.3



PRO G NW300 - Gratings

Code	Description		Load rating	Length (mm)	Width (mm)	Depth (mm)	Weight (kg)
17030102A	FILCOTEN PRO G ductile iron mesh grating NW300, MW 29/13, Inc Bolts		D400	500	347	25	15.2
17030103A	FILCOTEN PRO G ductile iron mesh grating NW300, MW 29/13, Inc Bolts		E600	500	347	25	17.9
17030107A	FILCOTEN PRO G ductile iron slotted grating NW300, SW 14/145, Inc Bolts		F900	500	347	25	24.5

Filcoten product selector

Filcoten Pro V

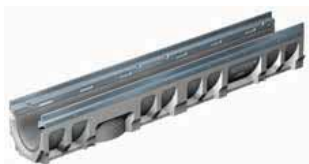

FILCOTEN PRO V Channel NW100 Galvanised Steel Edge, without slope

Code	Description	Load rating	Length (mm)	Width (w) (mm)	Height (h) (mm)	Invert (i) (mm)	Weight (kg)
10610200	FILCOTEN PRO V NW100 Nr. 0, without slope	E600	1000	138	142	120	18.3
10610261	FILCOTEN PRO V NW100 Nr. 5-0, without slope	E600	1000	138	170	150	21.6
10610262	FILCOTEN PRO V NW100 Nr. 10-0, without slope	E600	1000	138	195	170	24.9
10610264	FILCOTEN PRO V NW100 Nr. 20-0, without slope	E600	1000	138	245	220	29.9
10610280	FILCOTEN PRO V NW100 Nr. 0, L=500mm, without slope	E600	500	138	142	120	9.6
10610281	FILCOTEN PRO V NW100 Nr. 5-0, L=500mm, without slope	E600	500	138	170	150	10.8
10610282	FILCOTEN PRO V NW100 Nr. 10-0, L=500mm, without slope	E600	500	138	195	170	12.45
10610284	FILCOTEN PRO V NW100 Nr. 20-0, L=500mm, without slope	E600	500	138	245	220	14.95

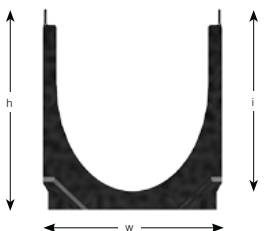

Filcoten®

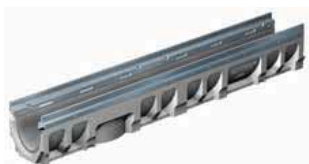

FILCOTEN PRO V Channel NW150 Galvanised Steel Edge, without slope

Code	Description	Load rating	Length (mm)	Width (w) (mm)	Height (h) (mm)	Invert (i) (mm)	Weight (kg)
10615200	FILCOTEN PRO V NW150 Nr. 0, without slope	E600	1000	188	210	190	31.2
10615261	FILCOTEN PRO V NW150 Nr. 5-0, without slope	E600	1000	188	235	215	34.1
10615262	FILCOTEN PRO V NW150 Nr. 10-0, without slope	E600	1000	188	260	240	37.9
10615264	FILCOTEN PRO V NW150 Nr. 20-0, without slope	E600	1000	188	310	290	46.9
10615280	FILCOTEN PRO V NW150 Nr. 0, L=500mm, without slope	E600	500	188	210	190	15.8
10615281	FILCOTEN PRO V NW150 Nr. 5-0, L=500mm, without slope	E600	500	188	235	215	20.9
10615282	FILCOTEN PRO V NW150 Nr. 10-0, L=500mm, without slope	E600	500	188	260	240	19.1
10615284	FILCOTEN PRO V NW150 Nr. 20-0, L=500mm, without slope	E600	500	188	310	290	23.5

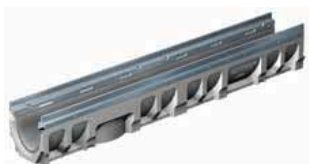
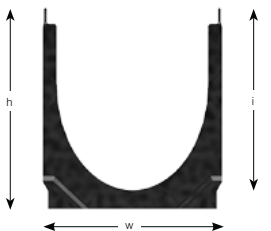

FILCOTEN PRO V Channel NW200 Galvanised Steel Edge, without slope

Code	Description	Load rating	Length (mm)	Width (w) (mm)	Height (h) (mm)	Invert (i) (mm)	Weight (kg)
10620200	FILCOTEN PRO V NW200 Nr. 0, without slope	E600	1000	238	265	245	45.4
10620261	FILCOTEN PRO V NW200 Nr. 5-0, without slope	E600	1000	238	290	270	49
10620262	FILCOTEN PRO V NW200 Nr. 10-0, without slope	E600	1000	238	315	295	53.9
10620264	FILCOTEN PRO V NW200 Nr. 20-0, without slope	E600	1000	238	365	345	62.7
10620280	FILCOTEN PRO V NW200 Nr. 0, L=500mm, without slope	E600	500	238	265	245	22.2
10620281	FILCOTEN PRO V NW200 Nr. 5-0, L=500mm, without slope	E600	500	238	290	270	25.8
10620282	FILCOTEN PRO V NW200 Nr. 10-0, L=500mm, without slope	E600	500	238	315	295	27.2
10620284	FILCOTEN PRO V NW200 Nr. 20-0, L=500mm, without slope	E600	500	238	365	345	31.4

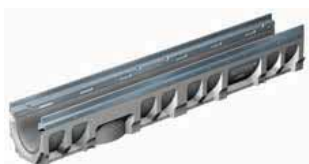
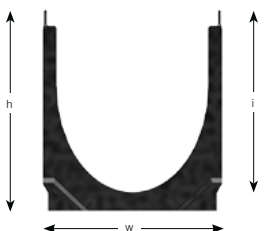

FILCOTEN PRO V Channel NW300 Galvanised Steel Edge, without slope

Code	Description	Load rating	Length (mm)	Width (w) (mm)	Height (h) (mm)	Invert (i) (mm)	Weight (kg)
10630200	FILCOTEN PRO V NW300 Nr.0, without slope	F900	1000	360	360	325	74.3
10630262	FILCOTEN PRO V NW300 Nr.10, without slope	F900	1000	360	410	375	87.3
10630264	FILCOTEN PRO V NW300 Nr.20, without slope	F900	1000	360	460	425	107.7

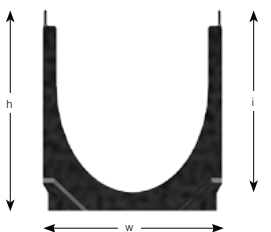

Filcoten product selector

Filcoten Pro V



PRO V NW100 - Gratings

Code	Description	Load rating	Length (mm)	Width (mm)	Depth (mm)	Weight (kg)
17010110	FILCOTEN PRO V ductile iron bar grating NW100, MW 28/9	D400	500	122	20	3.4
17010105	FILCOTEN PRO V ductile iron slotted grating NW100, SW 14/100	E600	500	122	20	3.8



PRO V NW150 - Gratings

Code	Description	Load rating	Length (mm)	Width (mm)	Depth (mm)	Weight (kg)
17015104	FILCOTEN PRO V ductile iron bar grating NW150, MW 29/13 with four point snap locking	D400	500	172	20	5.2
17015105	FILCOTEN PRO V ductile iron slotted grating NW150, SW 14/150 with four point snap locking	E600	500	172	20	-



PRO V NW200 - Gratings

Code	Description	Load rating	Length (mm)	Width (mm)	Depth (mm)	Weight (kg)
17020104	FILCOTEN PRO V ductile iron bar grating NW200, MW 29/13, with four point snap locking	D400	500	222	20	7.7
17020105	FILCOTEN PRO V ductile iron slotted grating NW200, SW 14/200, with four point snap locking	E600	500	222	20	8.9

Filcoten TEC



FILCOTEN TEC Channel NW100 with Ductile Iron Heelsafe Grating

Code	Description	Load rating	Length (mm)	Width (w) (mm)	Height (h) (mm)	Invert (i) (mm)	Weight (kg)
10410700	FILCOTEN TEC Channel NW100 No. 0, 1000mm with level invert, complete with ductile iron Heelsafe grating	C250/D400	1000	130	135	100	19.8

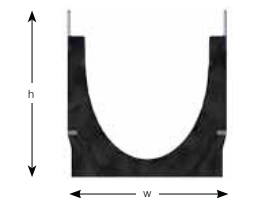

FILCOTEN TEC Channel NW100

Code	Description	Load rating	Length (mm)	Width (w) (mm)	Height (h) (mm)	Invert (i) (mm)	Weight (kg)
10410200	FILCOTEN TEC Channel NW100 No. 0, with level invert 1000mm	C250	1000	130	135	100	13

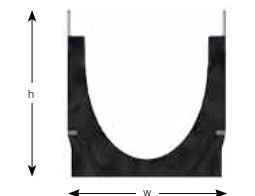

FILCOTEN TEC - Gratings

Code	Description	Load rating	Length (mm)	Width (mm)	Height (mm)	Weight (kg)
17010101	FILCOTEN TEC ductile iron bar grating NW100 MW 29/13	C250	500	122	20	3.2
17010206	FILCOTEN TEC galvanised slotted grating NW100, SW 8/80,	C250	1000	122	20	4.5
17010110	FILCOTEN TEC ductile iron bar grating NW100 MW 28/9	D400	500	122	20	3.4

Filcoten product selector

Filcoten SELF



FILCOTEN SELF Domestic Channel NW100 with Galvanised Steel Heelsafe Narrow Grating (A15kN)

Code	Description		Load rating	Length (mm)	Width (w) (mm)	Height (h) (mm)	Invert (i) (mm)	Weight (kg)
10710200	FILCOTEN SELF Channel NW100, 1000mm long, complete with galvanised steel slotted grating		A15	1000	130	135	85	13



FILCOTEN SELF Domestic Channel NW100 with Ductile Iron Grating with Snap-On locking (B125kN)

Code	Description		Load rating	Length (mm)	Width (w) (mm)	Height (h) (mm)	Invert (i) (mm)	Weight (kg)
10710100	FILCOTEN SELF Channel NW100, 1000mm long, complete with ductile iron grating		B125	1000	122	102	85	11.9

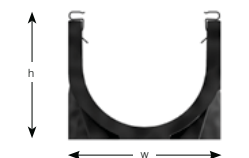

Filcoten®

Filcoten PAVE



FILCOTEN PAVE Domestic Channel NW100 with Galvanised Steel Slot Top for Paving

Code	Description		Load rating	Length (mm)	Width (w) (mm)	Height (h) (mm)	Invert (i) (mm)	Weight (kg)
10710203	FILCOTEN SELF Channel NW100, 1000mm complete with galvanised steel pave slot top		B125	1000	122	201	85	12.1
10710283	FILCOTEN SELF NW100, 500mm, incl. slot top galvanised steel NW100, asym., SW12.5 cl.B125kN, SH80		B125	500	122	201	85	8.7
10710293	FILCOTEN SELF NW100, sump unit, incl. maintenance unit galv. steel, asym., SW12.5 cl.B125kN, SH80		B125	500	122	481	85	21.1

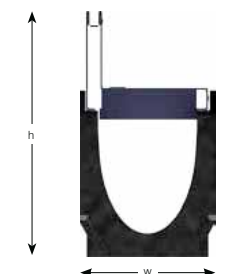

Filcoten GREEN



FILCOTEN GREEN Channel

Code	Description		Load rating	Length (mm)	Width (w) (mm)	Height (h) (mm)	Invert (i) (mm)	Weight (kg)
10630164	FILCOTEN GREEN channel without slope 1000mm		E600	1000	360	460	400	110
10630174	FILCOTEN GREEN channel without slope, with outlet 1000mm		E600	1000	360	460	400	107

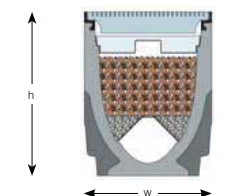

FILCOTEN GREEN Grating

Code	Description		Load rating	Length (mm)	Width (w) (mm)	Depth (d) (mm)	Invert (i) (mm)	Weight (kg)
17030222	FILCOTEN galvanised steel grating 1000mm		C250	1000	347	25	-	23.1
17030223	FILCOTEN galvanised steel grating 500mm		C250	500	347	25	-	11.6
17030102	FILCOTEN ductile iron bar grating		D400	500	347	25	-	15.2
17030103	FILCOTEN ductile iron bar grating		E600	500	347	25	-	17.9



Filcoten product selector

Accessories

Filcoten PRO G



PRO G NW100 - Accessories

Code	Description	Load rating	Length (mm)	Width (mm)	Depth (mm)	Weight (kg)
10610190	FILCOTEN PRO G sump unit NW100, 500mm long c/w pipe coupling DN100	F900	500	138	600	23.9
22515	FILCOTEN PRO G sump unit silt bucket NW100	-	385	92	112	0.2
19010215	FILCOTEN PRO G Closing End Cap, NW100, galvanised Steel (No. 15-0, 20-0)	-	1.5	130	245	0.3
19010216	FILCOTEN PRO G Outlet End Cap, NW100, with outlet DN100, galvanised Steel (No. 15-0, 20-0)	-	51.5	130	245	0.5
32103	FILCOTEN PRO G Security Locking Kit, NW100	-	-	-	-	0.02

PRO G NW150 - Accessories

Code	Description	Load rating	Length (mm)	Width (mm)	Depth (mm)	Weight (kg)
10615190	FILCOTEN PRO G Sump Unit NW100, 500mm long c/w pipe coupling DN100	F900	500	188	690	45.0
22516	FILCOTEN PRO G Sump Unit Silt bucket NW150	-	430	138	125	0.3
19015215	FILCOTEN PRO Front/end cap NW150 galvanised steel (0 up to 20-0)	-	1.5	180	310	0.5
19015216	FILCOTEN PRO outlet end cap NW150 with outlet DN150 galvanised steel (0 up to 20-0)	-	51.5	180	310	0.7
32103	FILCOTEN PRO G Security Locking Kit (NW150)	-	-	-	-	0.02

PRO G NW200 - Accessories

Code	Description	Load rating	Length (mm)	Width (mm)	Depth (mm)	Weight (kg)
10620190	FILCOTEN PRO G sump unit NW200, with pipe coupling DN200	F900	500	365	750	48.4
22512	FILCOTEN PRO G silt bucket for sump unit NW200	-	465	180	350	0.7
19020215	FILCOTEN PRO Front/end cap NW200 galvanised steel (0 up to 20-0)	-	1.5	230	359	0.8
19020216	FILCOTEN PRO outlet end cap NW150 with outlet DN200 galvanised steel (0 up to 20-0)	-	81.5	234	365	1.2
32103	FILCOTEN PRO G locking device kit M8, V (NW100-200)	-	-	-	-	0.02

PRO G NW300 - Accessories

Code	Description	Load rating	Length (mm)	Width (mm)	Depth (mm)	Weight (kg)
10630190	FILCOTEN PRO G sump unit NW300, with pipe coupling DN200	F900	560	520	950	124
22213	FILCOTEN PRO G silt bucket for sump unit NW300	-	380	285	320	3.2
19030213	FILCOTEN PRO G front/end cap NW300, closed, galvanised (No. 0-20)	-	1.5	358	460	1.7
19030214	FILCOTEN PRO G end cap NW300, with outlet DN200, galvanised (No. 0-20)	-	107	358	460	1.6
32110	FILCOTEN PRO G locking device kit M10 V (NW300)	-	-	-	-	0.02



Filcoten®

Filcoten product selector

Accessories

Filcoten PRO V



PRO V NW100 - Accessories

Code	Description	Load rating	Length (mm)	Width (mm)	Depth (mm)	Weight (kg)
10610290	FILCOTEN PRO V sump unit NW100, with pipe coupling DN100	E600	500	145	600	2304
22515	FILCOTEN PRO V sump unit silt bucket NW100	-	385	92	112	0.2
19010215	FILCOTEN PRO V Closing End Cap, NW100, galvanised Steel (No. 15-0, 20-0)	-	1.5	130	245	0.3
19010216	FILCOTEN PRO V Outlet End Cap, NW100, with outlet DN100, galvanised Steel (No. 15-0, 20-0)	-	51.5	130	245	0.5

PRO V NW150 - Accessories

Code	Description	Load rating	Length (mm)	Width (mm)	Depth (mm)	Weight (kg)
10615290	FILCOTEN PRO V sump unit NW150, with pipe coupling DN 150	E600	500	200	690	44.5
22516	FILCOTEN PRO V Sump Unit Silt bucket NW150	-	430	138	125	0.3
19015215	FILCOTEN PRO Front/end cap NW150 galvanised steel (0 up to 20-0)	-	1.5	180	310	0.5
19015216	FILCOTEN PRO outlet end cap NW150 with outlet DN150 galvanised steel (0 up to 20-0)	-	51.5	180	310	0.7

PRO V NW200 - Accessories

Code	Description	Load rating	Length (mm)	Width (mm)	Depth (mm)	Weight (kg)
10620290	FILCOTEN PRO V sump unit NW150, with pipe coupling DN 150	E600	500	200	690	48.0
22512	FILCOTEN PRO V silt bucket for sump unit NW200	-	465	180	350	0.7
19020215	FILCOTEN PRO Front/end cap NW200 galvanised steel (0 up to 20-0)	-	1.5	230	359	0.8
19020216	FILCOTEN PRO outlet end cap NW150 with outlet DN200 galvanised steel (0 up to 20-0)	-	81.5	234	365	1.2

PRO V NW300 - Accessories

Code	Description	Load rating	Length (mm)	Width (mm)	Depth (mm)	Weight (kg)
10630190	FILCOTEN PRO V sump unit NW300, with pipe coupling	560	360	950	124	48.0
22213	FILCOTEN PRO V silt bucket for sump unit NW300	380	285	320	3.2	0.7
19030213	FILCOTEN PRO V Front/end cap stainless steel	1.5	358	460	1.7	0.8
19030214	FILCOTEN PRO V End Cap with Outlet DN200	107	358	460	1.6	1.2

Filcoten TEC



FILCOTEN TEC - Accessories

Code	Description	Load rating	Length (mm)	Width (w) (mm)	Height (h) (mm)	Weight (kg)
10410790	FILCOTEN TEC, NW100, sump unit incl. ductile iron bar grating NW100, MW 28/9	C250	500	144	500	27.6
22515	FILCOTEN TEC, sump unit silt bucket NW100	-	385	92	112	0.2
10410200	FILCOTEN TEC, NW100 No. 0, without slope	-	1000	130	135	13
19010230	FILCOTEN TEC front/end cap NW100, closed, galvanised (No. 0-10)	-	1.5	128	185	0.3
19010231	FILCOTEN TEC end cap NW100, with outlet DN100, galvanised (No. 0-10)	-	51.5	130	185	0.4
19011204	Vertical bottom outlet NW100 galvanised steel	-	61.25	120	130	0.3
19011304	Vertical bottom outlet NW100 stainless steel	-	61.25	120	130	0.3

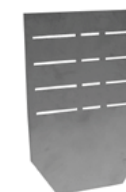

Filcoten product selector

Accessories

Filcoten SELF

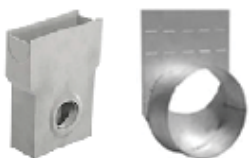

FILCOTEN SELF - Accessories

Code	Description	Load rating	Length (mm)	Width (mm)	Depth (mm)	Weight (kg)
10710290	FILCOTEN SELF NW100, sump unit incl. slotted grating, car accessible (SW5/80) and silt bucket	A15	500	138	382	17.8
10710190	FILCOTEN SELF NW100, sump unit, incl. ductile iron mesh grating and silt bucket	B125	500	138	385	19.6
19010221	FILCOTEN SELF front/end cap NW100, closed, galvanised	-	122	1.25	95	0.1
19010222	FILCOTEN SELF front/end cap NW100, with outlet DN 100, galvanised	-	122	62	155	0.4

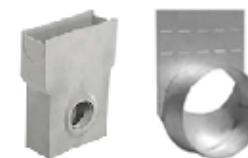

Filcoten®

Filcoten PAVE

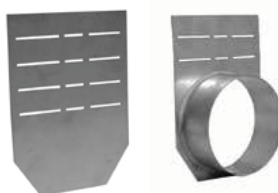

FILCOTEN PAVE Channel, Slot Top & Accessories

Code	Description	Load rating	Length (mm)	Width (mm)	Depth (mm)	Invert (mm)	Weight (kg)
10710000	FILCOTEN SELF NW100, BH95, without slope	B125	1000	122	96.5	85	7.75
10710080	FILCOTEN LIGHT NW100, BH95, L=500 mm, without slope	B125	500	122	96.5	85	4.43
17110237	FILCOTEN Slot top galvanised steel NW100, asymmetric, SW 12,5 cl. B 125 kN, 1000/123/103/SH80	B125	1000	123	103	80	4.36
17110238	FILCOTEN Slot top galvanised steel NW100, asymmetric, SW 12,5 cl. B 125 kN, 500/123/103/SH80	B125	500	123	103	80	2.21
17110297	Maintenance unit galvanised steel NW100, asymmetric, SW 12,5 cl. B 125 kN	-	500	123	103	80	4.1
17110280	Front cap V NW100 and NW150, variable height 80 - 200, galvanised steel	-	-	-	-	-	0.02

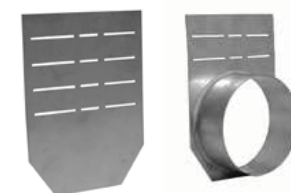

Filcoten GREEN



FILCOTEN GREEN Accessories

Code	Description	Length (l) (mm)	Width (w) (mm)	Depth (d) (mm)	Weight (kg)
19030313	FILCOTEN closed front / end cap NW300 stainless steel	15	358	460	3.00
19530911	FILCOTEN coarse dirt tray / sediment-step, stainless steel	-	-	-	1.00
19530950	FILCOTEN ENREGIS unit complete (with coarse dirt tray) for 1m FILCOTEN green	-	-	-	80 plm
19530951	FILCOTEN ENREGIS unit complete (without coarse dirt tray) for 1m FILCOTEN green	-	-	-	79 plm

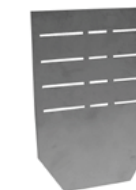

GATIC® ProSlot



Overview

Until recently, slot drainage systems have only been available for complex specification projects. But that has all changed with ProSlot – the first and only 'off-the-shelf' slot drainage system ideal for smaller projects. It is easy to install and comes with minimal transportation and maintenance cost.

ProSlot comes with the exceptional drainage capacity, unobtrusive profile and unique channel shape of our Slotrain system. We've done all the hard work in design, production and pre-assembly - so you don't have to.

Benefits of ProSlot:

- Efficient at disposing of large and small volumes of surface water
- Intake throat features a divergent taper that helps prevent blockages
- Same smooth, galvanised internal finish and 'V' section bottom as Slotrain to maintain good flow at low volume. This maximises self-cleansing
- Discreet once installed
- Fast and simple to install: all you have to do is slot together the sections, which come ready-fitted with injection moulded push-fit end piece connectors

Available in two ranges: **Cast** and **Pave**, ProSlot can be used neatly and efficiently with paving and concrete, as well as tarmac. ProSlot Cast is ideal for asphalt surfaces. ProSlot Pave is also available in Stainless Steel.

Load classification: A15 to D400



Applications:

- Landscaping and Pedestrian Schemes
- Car Parks
- Shopping Centres and Retail Parks



ProSlot Cast



ProSlot Pave

Sustainable

A significant proportion of the raw materials used are from recycled sources. Our plastic components are manufactured using reprocessed materials, such as old car bumpers, to help cut down on landfill waste.

Site Work and Maintenance Guide

Our illustrated literature includes advice and general information on safe handling, installation and maintenance of our products. This can be downloaded from our website www.gatic.com. Alternatively, email or phone us to request a copy.

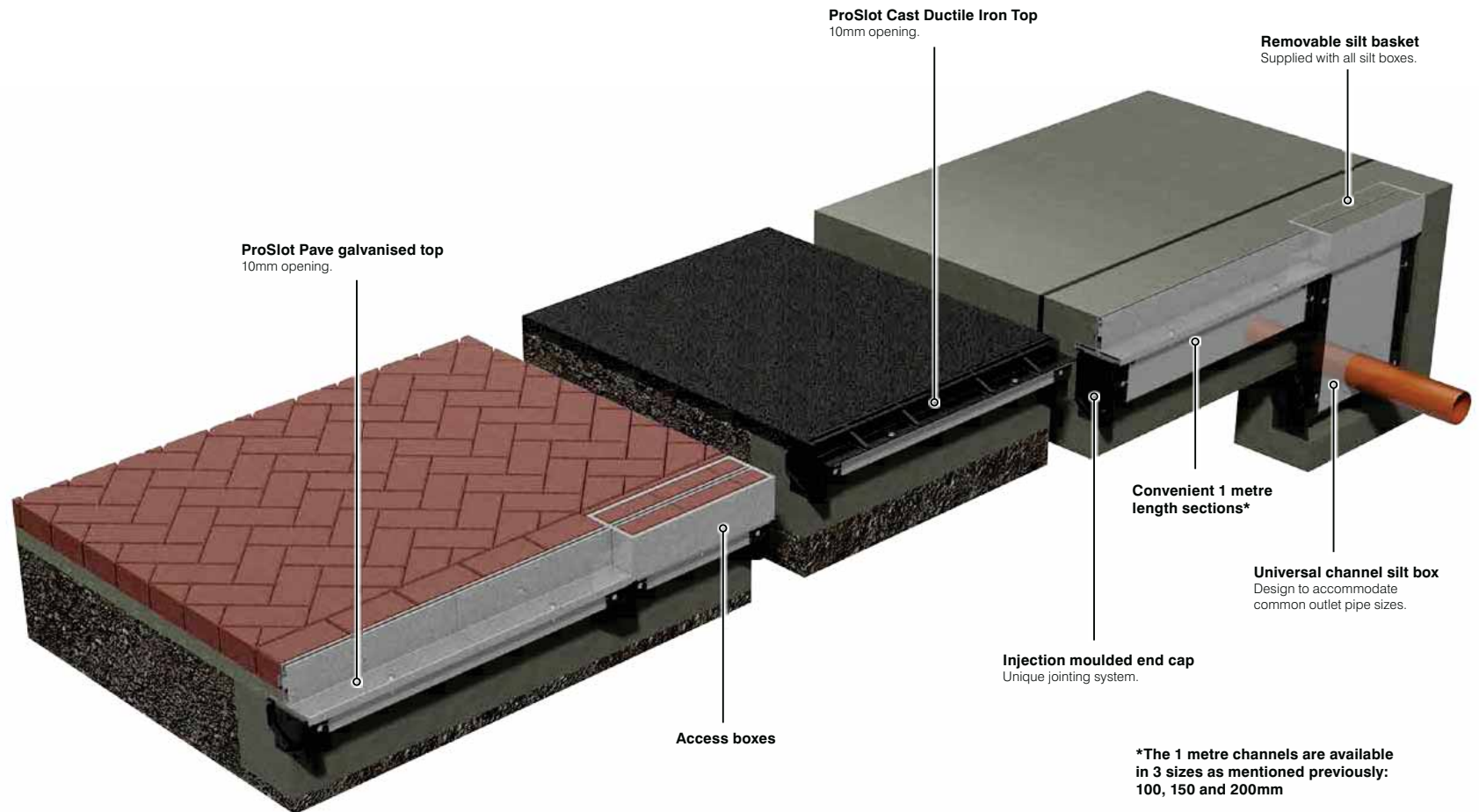

ProSlot product selector

Gatic ProSlot Cast

Load rated to D400, ProSlot Cast is a simple, pre-assembled and easy to install drainage system ideal for use in areas that carry light vehicular traffic and heavy pedestrian traffic, such as shopping centres, car parks and community amenities.

Load classification: A15 to D400



Applications:

- Landscaping and Pedestrian Schemes
- Car Parks
- Shopping Centres and Retail Parks



Gatic ProSlot Pave

ProSlot Pave is ideal for use with paved, block or concrete surfaces such as residential and pedestrian areas. With its steel top and unobtrusive throat, ProSlot Pave blends into the background and enables the sharp design or landscaped areas to live up to their full potential. ProSlot Pave is also available in Stainless Steel.

Load classification: A15 to D400



Applications:

- Landscaping and Pedestrian Schemes
- Car Parks
- Shopping Centres and Retail Parks



Slotdrain product selector

Gatic ProSlot



Cast

Code	Product	Top	Load Rating	Length (mm)	Width (w) (mm)		Height (h) (mm)	Invert (i) (mm)	Throat Depth (t) (mm)	Slot Orifice (mm)	Intake Area/ Metre (mm²)	Weight (kg)
A111005	PROSLOT 100	Cast	D400	1000	170		165	135	45	8	7272	15
A111010	PROSLOT 150	Cast	D400	1000	170		255	225	45	8	7272	17
A111015	PROSLOT 200	Cast	D400	1000	170		381	351	45	8	7272	20

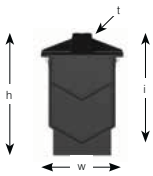

Pave

Code	Product	Top	Load Rating	Length (mm)	Width (w) (mm)		Height (h) (mm)	Invert (i) (mm)	Throat Depth (t) (mm)	Slot Orifice (mm)	Intake Area/ Metre (mm²)	Weight (kg)
A112005	PROSLOT 100	Pave	D400	1000	170		246	216	124	10	10000	13
A112010	PROSLOT 150	Pave	D400	1000	170		336	306	124	10	10000	15
A112015	PROSLOT 200	Pave	D400	1000	170		462	432	124	10	10000	18

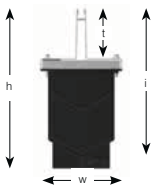

GATIC® ProSlot



Access Boxes

Code	Product	Top	Load Rating	Length (mm)	Width (w) (mm)		Height (h) (mm)	Invert (i) (mm)	Throat Depth (mm)	Slot Orifice (mm)	Intake Area/ Metre (mm²)	Box Weight (kg)	Cover Weight (kg)	Total Weight (kg)
A211005	PROSLOT 100 Access Box	Cast	D400	500	170		165	135	45	NA	NA	6	9	15
A211010	PROSLOT 150 Access Box	Cast	D400	500	170		255	225	45	NA	NA	7	9	16
A211015	PROSLOT 200 Access Box	Cast	D400	500	170		381	351	45	NA	NA	8	9	17
A212005	PROSLOT 100 Access Box	Pave	D400	500	170		246	216	124	10	5000	5	7	12
A212010	PROSLOT 150 Access Box	Pave	D400	500	170		336	306	124	10	5000	7	7	14
A212015	PROSLOT 200 Access Box	Pave	D400	500	170		462	432	124	10	5000	8	7	15

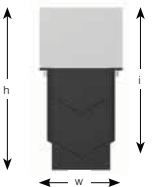
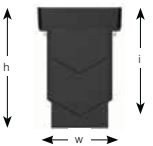

Silt Boxes

Code	Product	Top	Load Rating	Length (mm)	Width (w) (mm)		Height (h) (mm)	Invert (i) (mm)	Throat Depth (mm)	Slot Orifice (mm)	Intake Area/ Metre (mm²)	Box Weight (kg)	Cover Weight (kg)	Total Weight (kg)
A311005	PROSLOT Silt Box	Cast	D400	500	170		610	580	45	NA	N/A	17	7	24
A312005	PROSLOT Silt Box	Pave	D400	500	170		691	661	124	10	5000	14	7	21

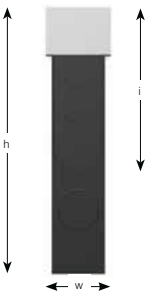

Outlets

Code	Product	Width (mm)		Invert (mm)	Total Weight (kg)
A411005	PROSLOT Outlet Male	As Channel		As Channel	1
A411010	PROSLOT Outlet Female	As Channel		As Channel	1

Harmer SML

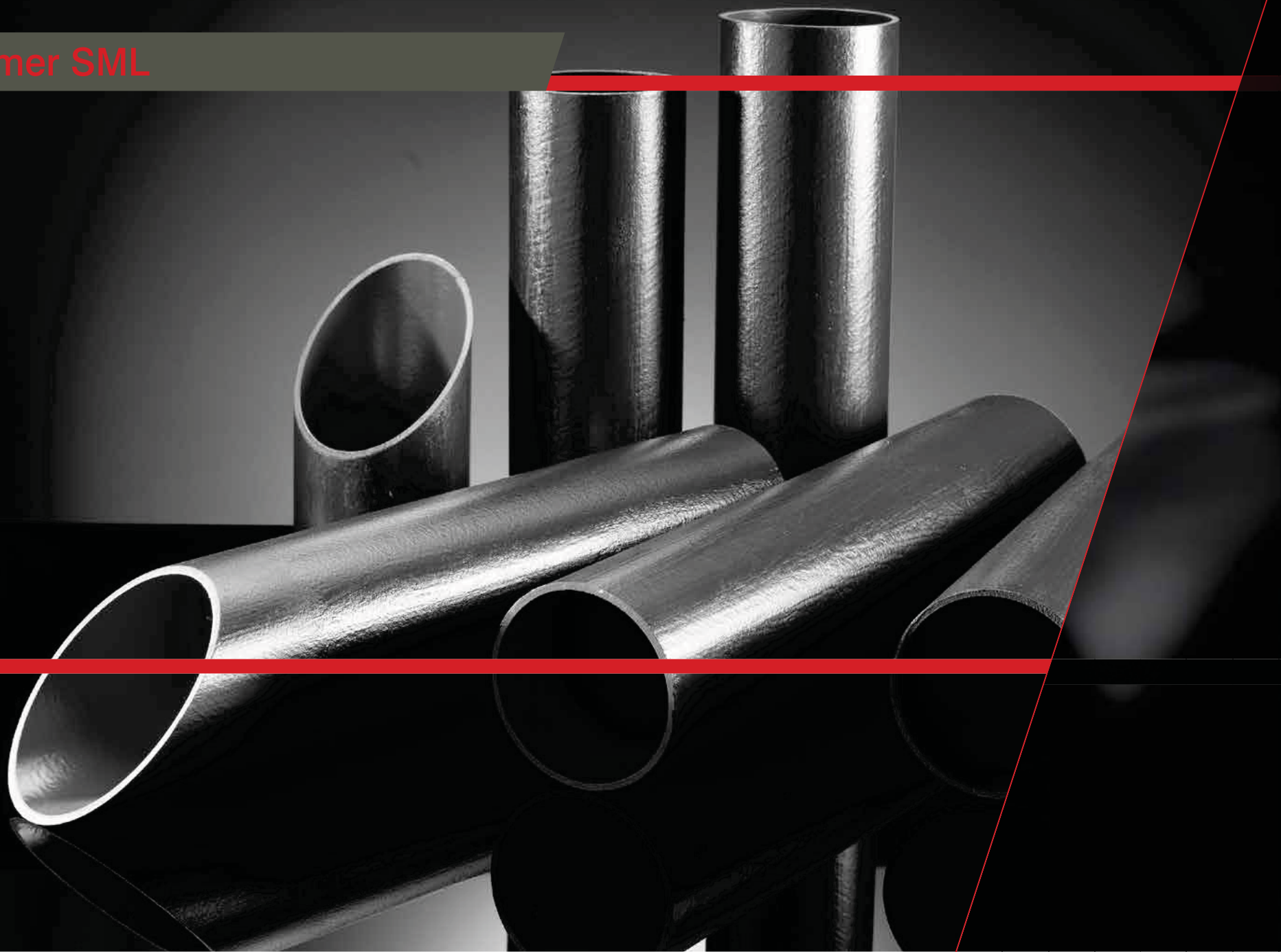

SML Below Ground Drainage



Overview

Harmer SML Below Ground Drainage Cast Iron Pipes and Fittings are manufactured and tested in accordance with the European Standard BS EN 877. Harmer SML Below Ground allows for direct connection from soil to drain to sewer.

Features & Benefits

- Full system of pipes, fittings & access chambers
- Fully compatible with Harmer SML above ground building drainage
- CE Conformity in accordance with BS EN 877
- Kitemark Accreditation - KM 613802
- BBA Agrément certified no. 05/4191
- 100% recyclable
- Harmer SML below ground is produced from 95% recycled material
- Robust, lightweight strong and durable
- Excellent load bearing strength
- Outside coating of SML below ground corresponds to BS EN 877 under BS EN ISO 13823
- Planning and installation of SML below ground pipelines in accordance with technical regulations of:
 - **BS EN 12056:** Gravity Drainage systems inside buildings
 - **BS EN 752:** Drain & Sewer systems outside buildings
 - **BS EN 1610:** Construction and testing of drains and sewers
 - **Approved Document H:** Drainage & Waste Disposal
 - **Sewers for Adoption:** A Design & Construction Guide for Developer



SML Below Ground - Product Range



Pipes

SML below ground pipes are available in standard 3 metre socket-less lengths, in diameters from 100mm to 400mm, providing a high performance, lightweight, below ground cast iron soil & waste system.

Pipes are produced by a state-of-the-art centrifugal casting process which produces consistent quality.



Branches

A range of fittings designed to connect multiple below ground pipes. Available in single and double branches as 45 degree and 88 degree in 100mm to 300mm diameter pipe sizes.



Couplings

SML below ground couplings are specially designed for joining lengths of SML below ground pipe work and for joints between pipes and fittings.

Couplings are available in stainless steel from 100mm to 400mm and in ductile iron from 100mm to 200mm.

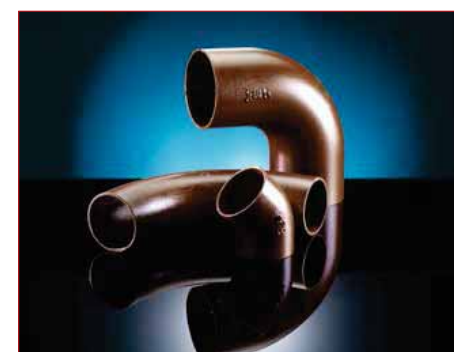

Bends and Offsets

A wide range of bends to accommodate change in direction, meeting a wide variety of design requirements, including single bends, long & medium radius bends and rest bends.

SML Below Ground - Product Range cont...



Access Fittings

Designed to allow access for inspection and rodding - includes round and square access doors and access bends.

Other Fittings

To complement the range there are also other fittings such as reducers from 100mm to 300mm, plain traps and blank ends from 100mm to 300mm.



Inspection Chambers & Bellmouth Gulleys

A range of inspection chambers from 100mm to 150mm with 45 degree branch connections.

Supplied with a removable cover allowing easy access for maintenance.

The System

SML Below Ground Coating

SML Below ground pipe systems meets all the requirements of BS EN 877 with CE declaration of conformity.

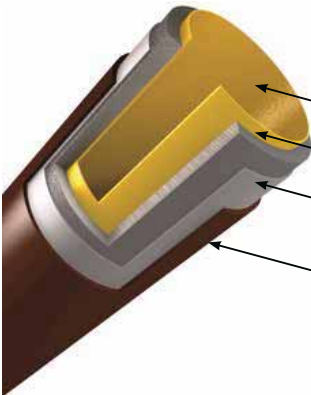

Epoxy coating with a minimum thickness of 120 µm with resistance that surpasses the requirements for EN 877.

Cast iron lamella graphite

Thermal spray zinc coating, surface density at least 130g/m²

SML below ground fittings receive a high quality epoxy powder coating in brown colour inside and out.

Why specify Cast Iron in below ground applications?

For centuries, cast iron has been a preferred material for building construction, because of its longevity in a wide range of applications. Advances in cast iron technology have ensured that today's products are fully attuned to modern construction needs.

Cast Iron is known as a low-risk material of choice for both specifiers and installers alike due to its 'fit-and-forget' properties. UV light degradation and the effect of mechanical damage are often key factors in material selection considered by specifiers and installers. Cast iron provides the key resistant benefits compared to other materials in below-ground pipe applications.

Cast Iron Soil & Waste pipe systems are renowned for their strength and reduction in risk of failure compared to other pipe materials. They offer a greater resistance to natural ground movement and less likely to fail in unfavourable ground conditions.

Other drainage materials need additional pipe protection in areas where ground disturbance or extra loading is likely, for example a covering concrete slab or concrete surround. No additional protection is required in most circumstances for a Cast Iron system, saving time, labour and material in construction costs.

The risk-analysis factors speak for themselves, when comparing like-for-like products using other materials - see table below.

Hazard	Clay	Plastic	Cast Iron
Settlement	High Risk	Medium Risk	Low Risk
Sheer Pressure	High Risk	Low Risk	Low Risk
Rodding Damage	Medium Risk	High Risk	Low Risk

SML Below Ground Planning & Installation

Planning and installation of SML Below Ground pipelines follow the technical regulations and stipulations of:

- BS EN 12056: Gravity drainage systems inside buildings
- BS EN 752: Drain and sewer systems outside buildings
- BS EN 1610: Construction and testing of drains and sewers

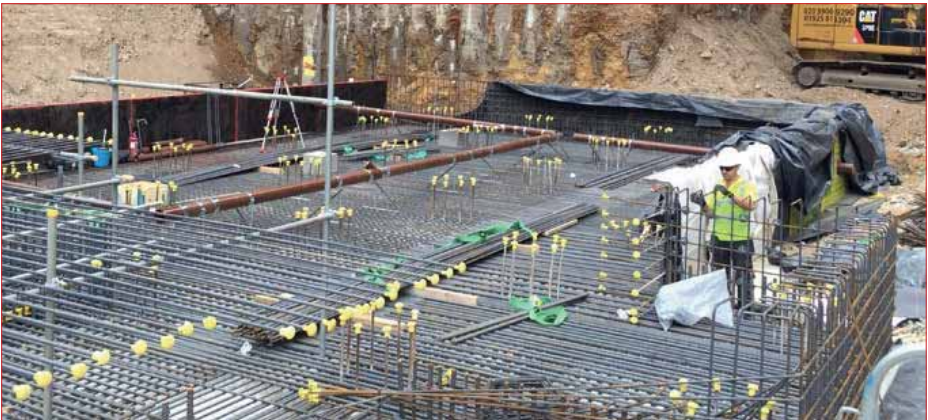

Interactive Website

Our website is ultra user-friendly and offers full details of our Slotrain surface water drainage systems, channel drainage and linear drainage. This includes features and benefits, sizes and load categories, as well as design service and contact information.

The website also contains dedicated Access Covers and StreetWise sections.



Slotrain Lite Brochure

A Lite brochure that offers an overview of our Slotrain product range, including key applications, features and benefits.



Site Work and Maintenance Guide
Illustrated literature giving advice and general information on safe handling, installation and maintenance of all our products.

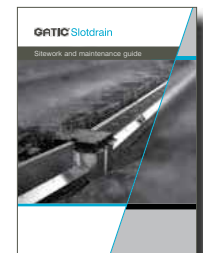

FREE Drainage Design Software

This interactive software allows you to design your own drainage system using the same programme as our in-house design engineers. For a USB containing this free software, simply register your details with us. You can do this on the MyGatic section of our website, or by emailing / phoning us.



Access Covers Product Selector Software

Our Gatic Access Covers Product Selector software is now available and can be sent to you on a USB for free. Simply register your details with us on the MyGatic section of our website, or by emailing / phoning us.





Gatic, Poulton Close, Dover CT17 0UF England

Tel: +44 (0) 1304 203 545 • Fax: +44 (0) 1304 215 001

Email: info@gatic.com • Website: www.gatic.com



MIX

FSC® C009463

All reasonable care has been taken in the preparation of this brochure, all information, recommendations and guidance notes on the use of The Products are made without guarantee since the conditions of use are beyond the control of Alumasc Exterior Building Products Limited (The Company). The customer is responsible for ensuring that each product is fit for its intended purpose and that conditions for use are suitable. The information contained in this brochure and advice arising therefrom is free of charge and accordingly on the terms that no liability nor liability for negligence will attach to the Company or its servants in relation to any such service arising out of or in connection with this brochure. The Company pursues a policy of constant product development and information contained in this publication is therefore subject to change without notice.